

City of
portland



WELCOME!

KIWANIS POOL
COMMUNITY MEETING

October 19, 2023



Counsilman · Hunsaker
AQUATICS FOR LIFE

TEAM INTRODUCTION



TATYANA VASHCHENKO
PROJECT MANAGER



ANGELA O'CONNER
ASSISTANT RECREATION
DIRECTOR



JULIA TATE

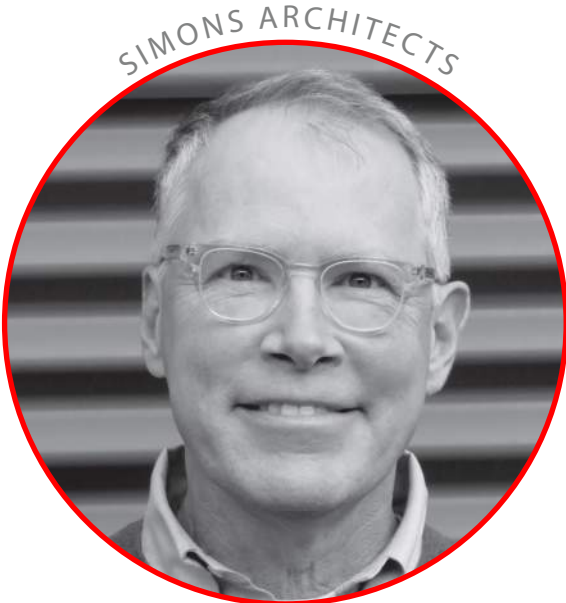

AUSTIN SMITH



CARL NYLANDER



CAITLIN ACETO



PAIGE LYONS

KIWANIS POOL



Massachusetts Ave

Massachusetts Ave

Douglass St

Douglass St

Douglass St

St James St

St James St

St James St

St John St

WHY RECONSTRUCT KIWANIS POOL?

Pool is Over 60 Years Old and is at The End of it's Usable Lifespan [1961]

Existing Pool has ADA Accessibility Challenges and Limitations

Existing Pool Limits Number of Occupants and Operating Hours

New pool would allow facility to align with City's Comprehensive Plan, newer Code, and Green Building Requirements

Existing Pool Limits Family Use [1:1 Child Parent Ratio]



C. 1963

PROJECT HISTORY TO DATE

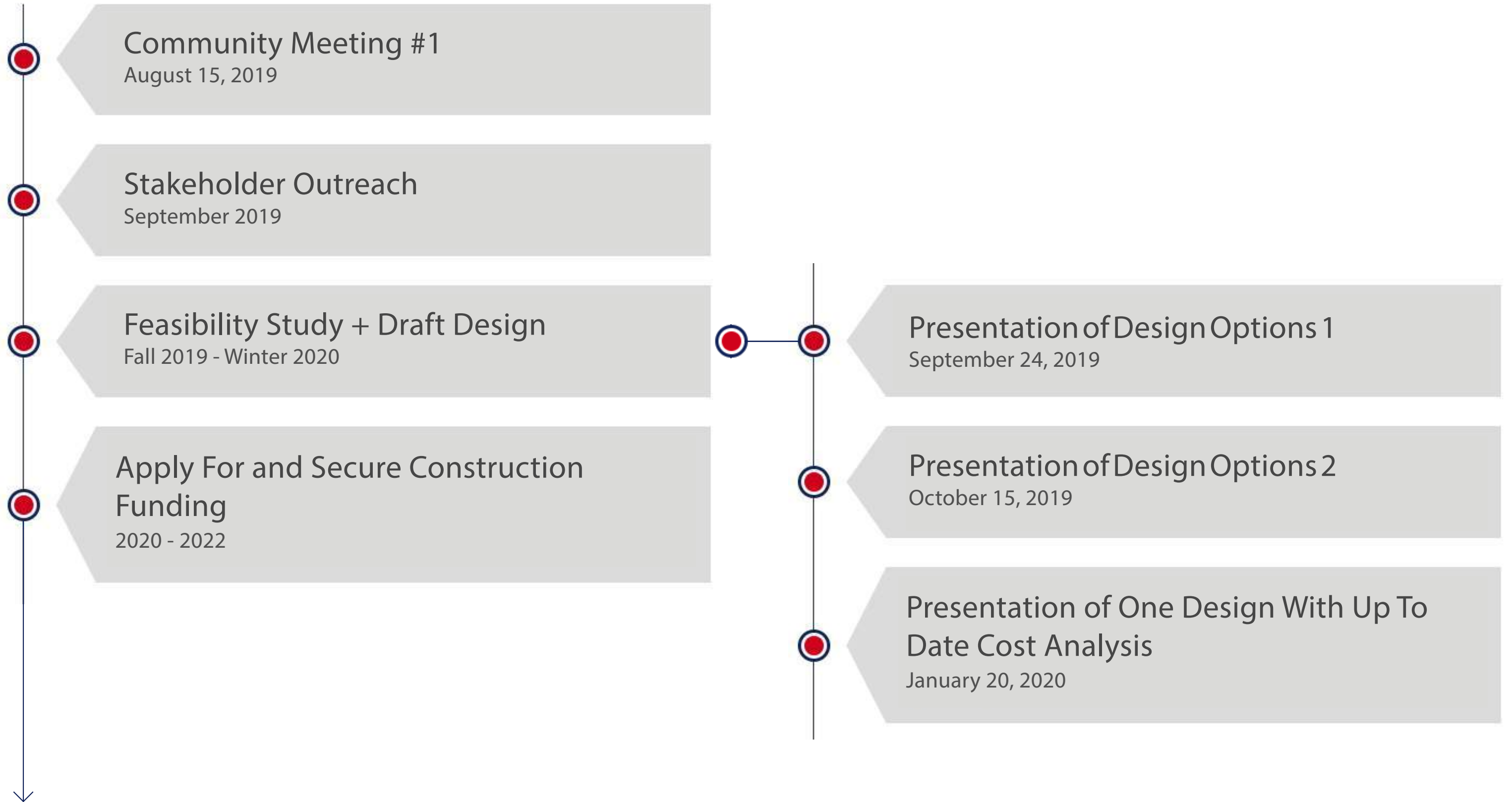

PROJECT SCHEDULE



FEASIBILITY STUDY PROCESS



Needs Assessment

- Evaluate area providers
- Research area demographics
- Identify user groups
- Identify potential community partners
- Site analysis



Facility Program & Space Requirements

- Develop schematic design options for programming
- Develop project cost estimates
- Identify potential partnerships



Operations & Business Plan

- Opinion of revenue
- Opinion of operating expenses
- Determine cash flow

DESIGN OPTION PRESENTATION [SEPT. 24, 2019]



PROJECT COMMITTEE FEEDBACK [THRU SEPT. 24, 2019]

TWO SEPARATE POOLS

8-LANE 25-YARD POOL CAN BE REDUCED TO 6-LANES

AMENITIES FOR CHILDREN WITH PARENTS ON DECK (KEEP SPLASHPAD!)

OPTIONS ARE REALISTIC AND KID FRIENDLY

POOL

- ZERO DEPTH ENTRY
- EXPANDED PLAY AREA FOR YOUNG CHILDREN
- CLIMBING WALL / SLIDES FOR OLDER KIDS AND TEENS
- DEEPER WATER FOR LAP LANES
- ABILITY TO USE SPASH PAD WHEN POOL IS CLOSED

DIVING BOARDS NOT ESSENTIAL; BUT DEEPER WATER IS NEEDED

FOCUS ON FAMILIES! [PRIMARY USERS]

BUILDING

- UPDATED BATH HOUSE
- OUTDOOR CONCESSIONS
- FAMILY CHANGING ROOMS
- BATHROOM ACCESS FROM BACK SIDE OF BATH HOUSE

DECK + SITE

- SHADE AND TABLES ON POOL DECK
- OUTDOOR LIGHTING
- SECURITY FENCING

NEW BATH HOUSE INSTEAD OF RENOVATED BATH HOUSE

GENERAL

- NEW POOL TO ALLOW FOR GREATER THAN EXISTING 1:1 CHILD / PARENT RATIO
- ADA ACCESS FROM STREET + PARKING
- ABILITY TO EXTEND POOL HOURS TO 8:00 PM
- POOL NAME: CONFUSING TO GENERAL PUBLIC

INCLUDE AMPLE PERIMETER DECK SPACE

FINAL CONCEPTUAL PLAN DIAGRAM [JAN. 20, 2022]

LAP POOL [3200 SF]

6, 25 YARD LANES

CLIMBING WALL

OPEN WATER RECREATION AREA

SWIM LESSONS / FITNESS / PROGRAM AREA

LEISURE POOL [3283 SF]

ZERO-BEACH ENTRY

CHILDREN'S PLAY STRUCTURE

OPEN WATER RECREATION AREA

DUAL WATER-SLIDE TOWER

SWIM LESSON / PROGRAM AREA

SPRAYPAD [1000 SF]

BUILDING + SUPPORT STRUCTURES

IMPROVED ENTRANCE EXPERIENCE

LOCKER ROOMS

FAMILY CHANGING RESTROOMS

CONCESSIONS

OFFICES

POOL MECHANICAL



COMMUNITY MEETING FOCUS GROUPS [JUL. 11, 2023]



COMMUNITY MEETING FOCUS GROUPS [JUL. 11, 2023]

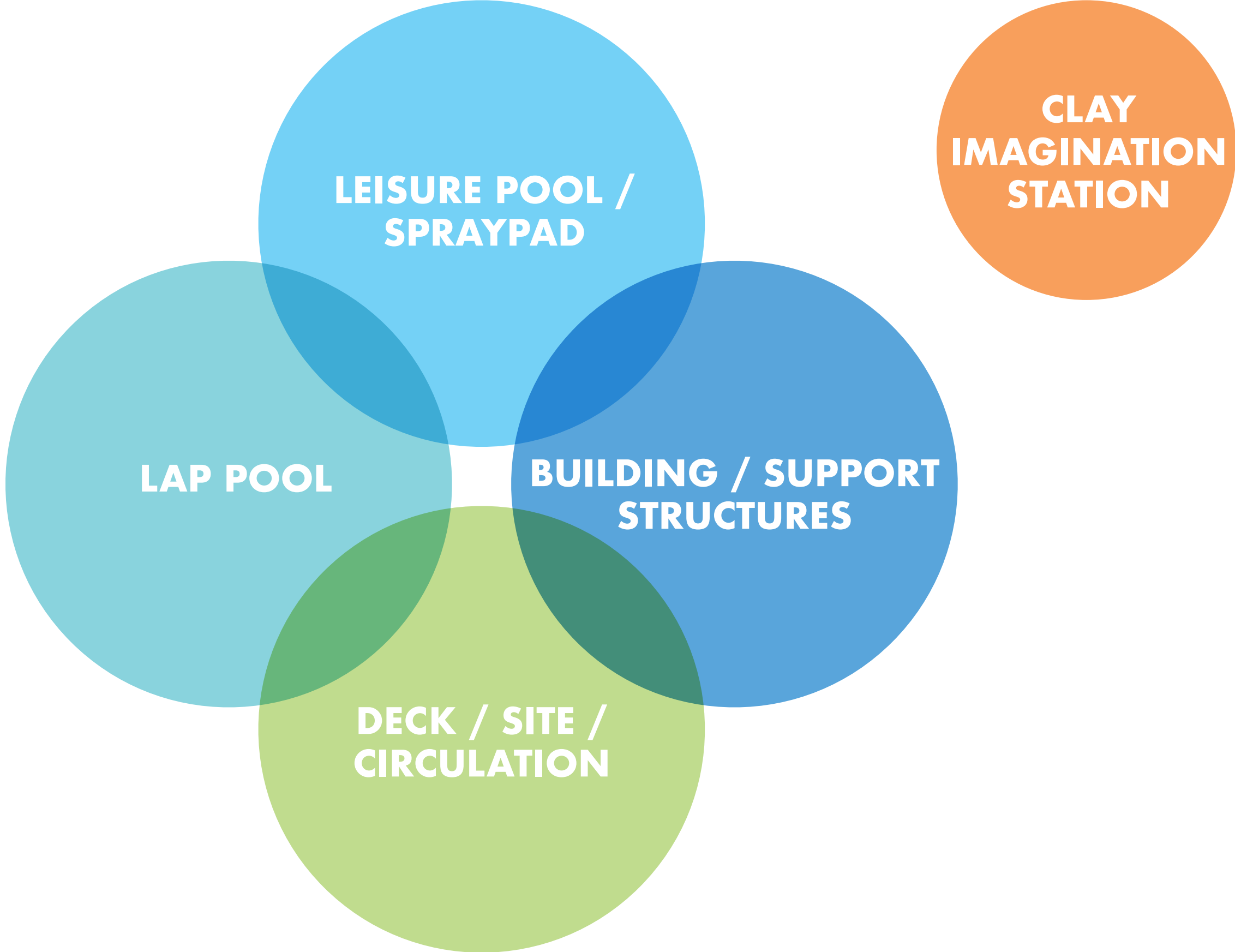

**LEISURE POOL /
SPRAYPAD**

**CLAY
IMAGINATION
STATION**

LAP POOL

**BUILDING / SUPPORT
STRUCTURES**

**DECK / SITE /
CIRCULATION**

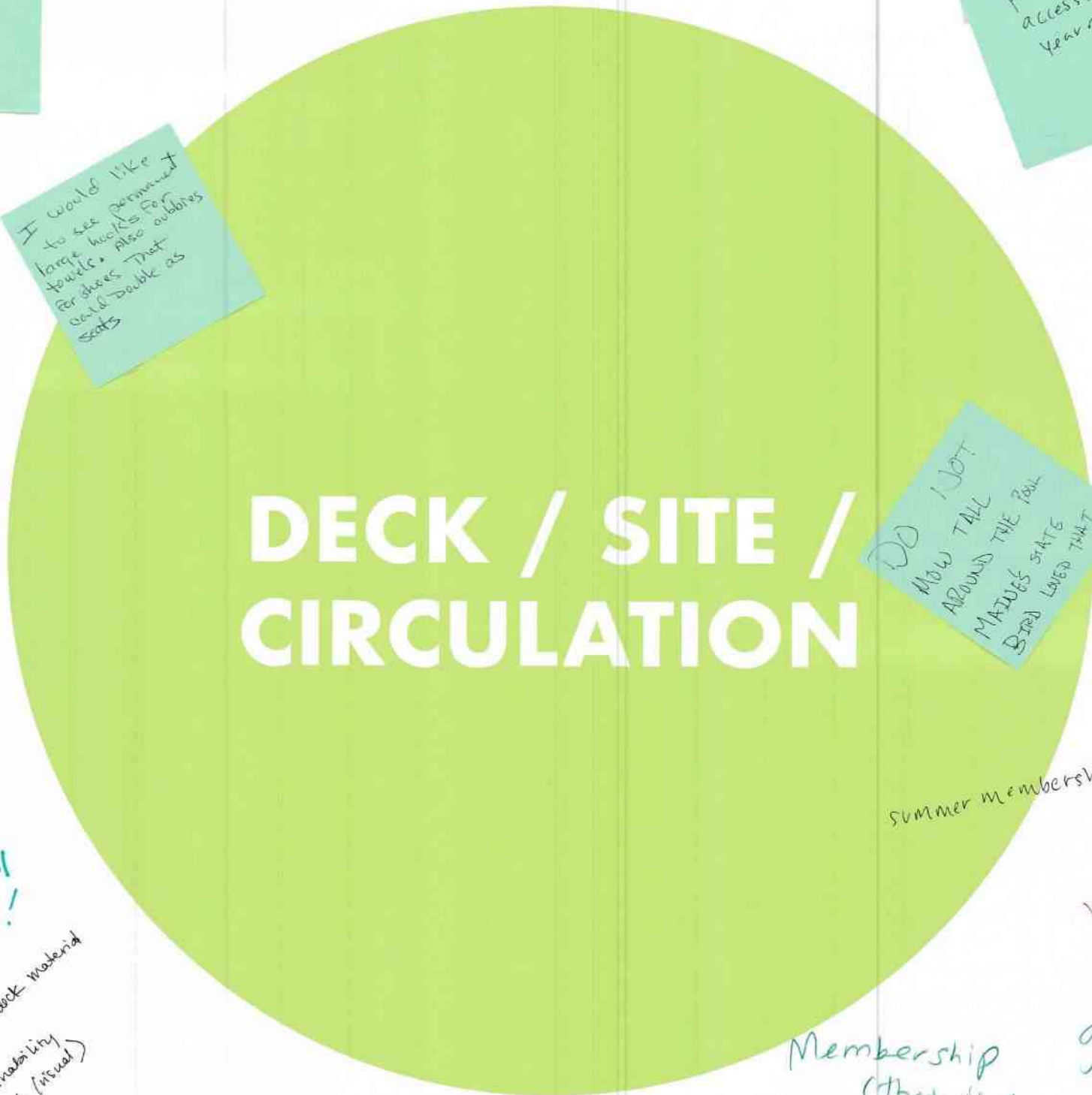

DECK / SITE / CIRCULATION

movement b/w splash pad & main deck - easy when pool is open, safe if pool is closed & splash pad stays open

Who is going to staff the concession stand?

I would like to see permanent large hooks for towels. Also address for shoes that could double as seats

Clearly mark existing food forest plantings so they are not damaged during construction
Invite community garden rep to preconstruction meeting

SHADE, SEATING, TRASH CANS.

Keep existing shade trees

Grass in fenced-in area with umbrellas
→ Look at Underwood Community Pool in Belmont, MA for example!
♡♡♡♡♡

Natural materials
rock, trees

non-imperious deck material
- safety
- sustainability
- appeal (visual)

→ Nason's cover playground may be inspiration

bicycle benefits!
* does the bike sticker incentive still exist? offer discount to cyclists!

be careful about how the project is presented - it may not go over well that we're spending \$6.5 m on the pool when there are people sleeping in the park

picnic tables accessible year-round

+1

Offer of splash pad for Bikes (parking for Bikes)
- Add more bike parking
- Offer of splash pad for Bikes (parking for Bikes)

Are concessions really needed - NOT create a mess and ask who will run for it? Not a good use of space!

What are pool amenities vs. what are community amenities? (bathroom, patios, food, etc)

DO NOT MOW TALL AROUND THE POOL MAZES STATE BIRD LOVED THAT

difficult to visit w/ more than 1 kid -

Not would like to help with the planting. The neighbor who did the community garden and playground loved helping. Kathy Lewis

summer membership

Keep the big trees near the splash pad
grass! little grassy area for sitting/shade w/ shade to grassy area for sitting/shade
Ditto

Membership (that is discounted)

No fence around spraypad

not just concrete!
Make the bottom to start the splash pad fan.
removable cover to make it 3-4 seasons

LAP POOL

Consider 25 meters vs yards

PLEASE KEEP LANE WIDTH IN CONSIDERATION.

SWIM FLAYS FOR LAP SWIM WOULD BE IDEAL.

No Climbing wall

PLEASE CONSIDER 25 METERS.

Ma? move Climbing wall

Please consider 25-meter pool

IF CONSIDERING 25 METERS, PLEASE DON'T SHRINK THE WIDTH OF LANES.

Could there be a bump-out to accommodate a diving board?

Consider changing to 25 meters

NOT SURE ABOUT A CLIMBING WALL

Prefer 25 meter pool. Also, care with plantings to keep pool free of leaf debris

Plant trees!! Global warming trumps the small complaint of leaf debris. Do not cut down trees!

Climbing wall seems like a great option during open swim

Please take a look at a 25 meter option w/ 7 ft lanes

ledge inside pool in deep water for lap swimmers to pause / guards to use for extrication

lap pool - "walking + exercise lane"

NO SWIM CAP REQUIREMENT FOR SWIMMERS NOT SWIM LAP.

Clear instructions/directions on circle swimming & lane speeds

LEISURE POOL / SPRAYPAD

Playground attached is nice! particularly for kids
pour water on

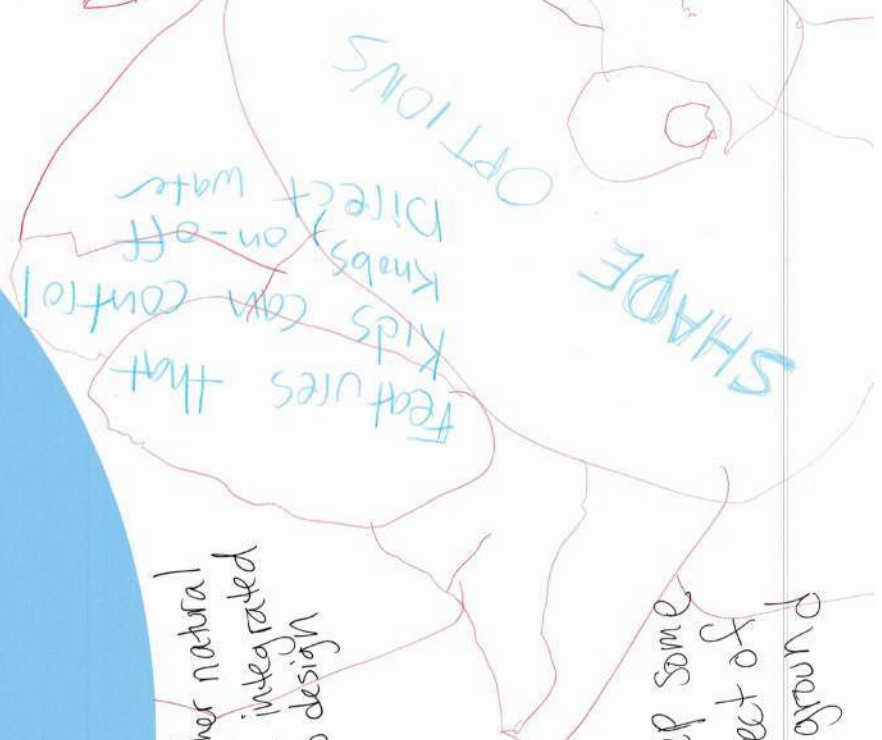

Keep some as part of playground

Granite for natural elements integrated into design

Salt water Chlorine! (for all Pools!)

LOTS of shade (keep established trees)

DONT SKIMP ON SPRAYPAD FEATURES & KID INTERACTIVITY
Picnic tables in shade

No more "rule pool" reputation
Design for safety w less enforcement

Water bottle fill station
Water fountain station
(accessible 24/7)
Spray is better than inches of water

Seating, shade!

Big trees in pots!

Wading pool like the one that sprays you when you go down (background elements in)

Check out White's Pool in Rutland VT great incorporation of fun splash elements for kids of all ages

Bicycle benefits (discounted entry if you bike!)

not just concrete surface (Yes!)

grass nearby
Seating - rocks?

fountains w/in pool

No fence around spraypad +!

Grass + shade all the way to the pool

Keep all existing trees!

shade trees here on south side

low ravine w/water slides in the water

Invite community garden rep to preconstruction meeting

Diving Board in deep water area of Leisure pool or lap pool. See Underwood pool in Belmont, MA for example.

SPRAY PAD } OPEN 24/7
Climate Resiliency Benefits
Expand season

BUILDING / SUPPORT STRUCTURES

Encourage taking the bus, walking, and biking to the pool

Year-round consideration → focus on this pool to defully operational and reduce other pool operations

Ditto → swipe card entry

Family changing room equal size and big open

Security and cleanliness of locker rooms if they are open all hours

more than 1 bathroom in women's bathroom outside cubbies/lockers on pool deck

renting equipment (shuttle) for 4th of July

Ditto → Very welcoming entrance.

BATHROOMS/LOCKER ROOMS AVAILABLE YEAR ROUND OUTSIDE BUILDING WATER BOTTLE REFILLING STATION

Gender Neutral Toilet

Highlight new playground that replaces old 40' x 40'

(oop) to get swimmers to donate shirts to extend hours or hrs. swim. some want to be recruited/required some shirts?

food trucks?

GRASS WITHIN POOL DECK

I love that current building at ref is light coming in locker room, ~~and into outdoor~~ feeling.

locker room circulation/orientation so people can maintain modesty → maybe locker rooms that dump onto the deck rather than the building



More light

* Keep an outdoor shower

NO TRASH CANS OUTSIDE OF POOL AREA

SOLAR PANELS ON THE ROOF

lifeguard space - break room - storage

Include Ice Cream w/ concessions

ask swim team parents to lifeguard

coordinate with PAYSA for access to locker room

WHAT WE HEARD [JULY 11, 2023]

INCREASE HOURS / SEASON OF USE

RESTROOMS ACCESSIBLE TO PARK, GARDEN AND POOL

SUSTAINABLE FEATURES: LEED, PVs, VEGETATED AREAS

LESS ENTHUSIASM FOR CLIMBING WALL

SUPPORT FOR DIVING BOARD

SLIDES FOR PLAY

INTERACTIVE PLAY FEATURES WITHIN SPRAYPAD

SPRAY / PLAY FEATURES WITHIN POOL

25 METERS VS. 25 YARDS

WALKING LANE SEPARATE FROM LAP LANES

FOCUS ON FAMILIES AND COMMUNITY USE!

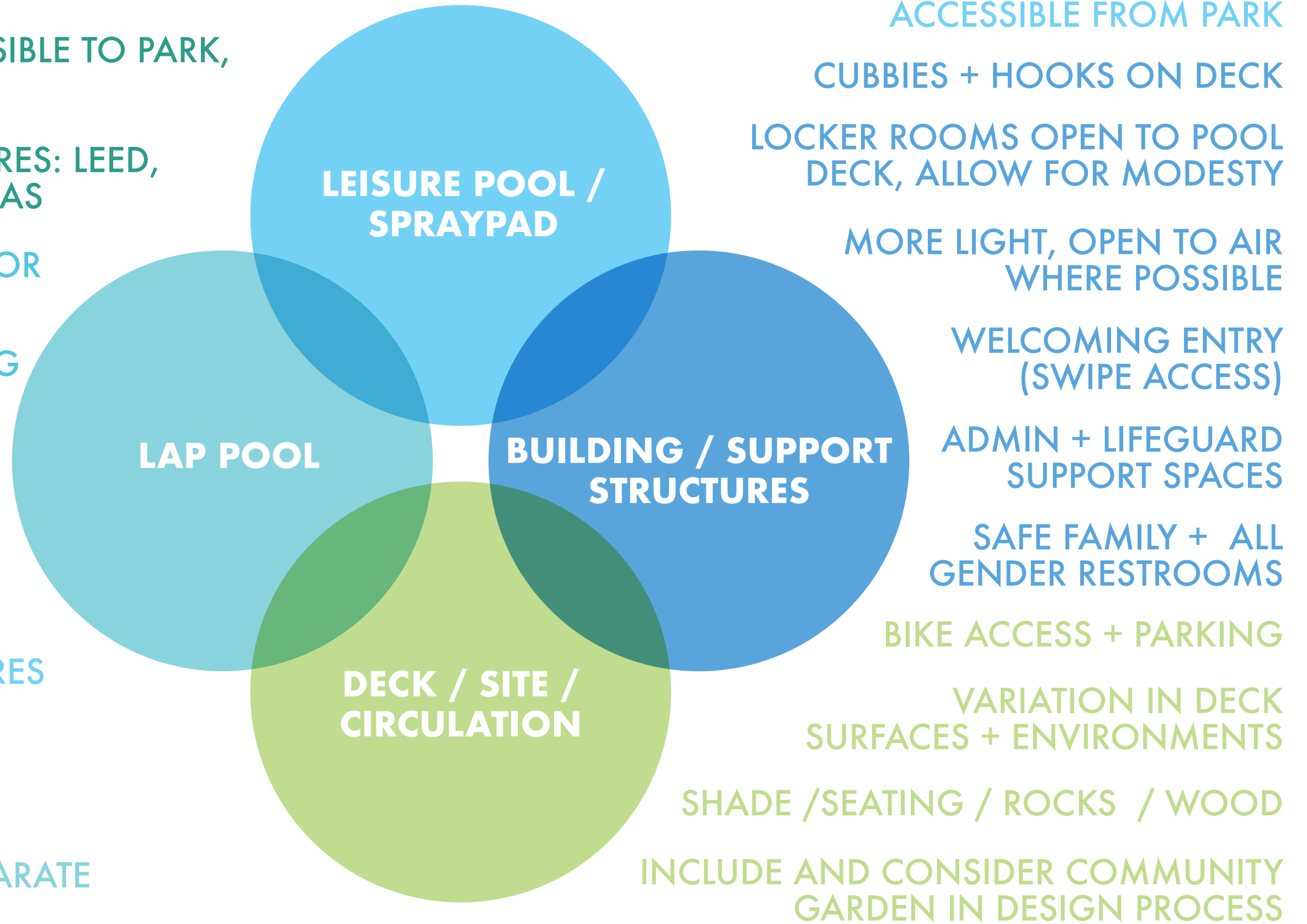

SPRAYPAD OPEN EXTENDED HOURS / SEPARATE FROM POOL / ACCESSIBLE FROM PARK

CUBBIES + HOOKS ON DECK

LOCKER ROOMS OPEN TO POOL DECK, ALLOW FOR MODESTY

MORE LIGHT, OPEN TO AIR WHERE POSSIBLE

WELCOMING ENTRY (SWIPE ACCESS)

ADMIN + LIFEGUARD SUPPORT SPACES

SAFE FAMILY + ALL GENDER RESTROOMS

BIKE ACCESS + PARKING

VARIATION IN DECK SURFACES + ENVIRONMENTS

SHADE / SEATING / ROCKS / WOOD

INCLUDE AND CONSIDER COMMUNITY GARDEN IN DESIGN PROCESS

EXISTING CONDITIONS



UPDATED SITE PLAN

LEGEND

- ① Entry Plaza (Douglass St. Orientation)
- ② Maintenance Access (St. James Orientation)
- ③ Leisure Pool
- ④ Lap Pool (25 yard)
- ⑤ Slide
- ⑥ Shade Shelter
- ⑦ Lawn Panel
- ⑧ Gate - Access to Splash Pad
- ⑨ Bathroom access from outside of pool deck
- ⑩ Splash Pad connector path
- ⑪ Maine Wilderness Splash Pad
- ⑫ Shade Shelter
- ⑬ Sloping Ball Field Spectator Lawn



Douglass Street

St. James Street



0 10 20 40

UPDATED SITE PLAN

LEGEND

- ① Entry Plaza (Douglass St. Orientation)
- ② Maintenance Access (St. James Orientation)
- ③ Leisure Pool
- ④ Lap Pool (25 yard)
- ⑤ Slide
- ⑥ Shade Shelter
- ⑦ Lawn Panel
- ⑧ Gate - Access to Splash Pad
- ⑨ Bathroom access from outside of pool deck
- ⑩ Splash Pad connector path
- ⑪ 'Maine Wilderness' Splash Pad
- ⑫ Shade Shelter
- ⑬ Scuppers in wall
- ⑭ Bike Rack
- ⑮ Large Shade Trees
- ⑯ Native Plantbeds
- ⑰ Native Plantbeds
- ⑱ Shrub Windbreak
- ⑲ Sloping Ball Field Spectator Lawn

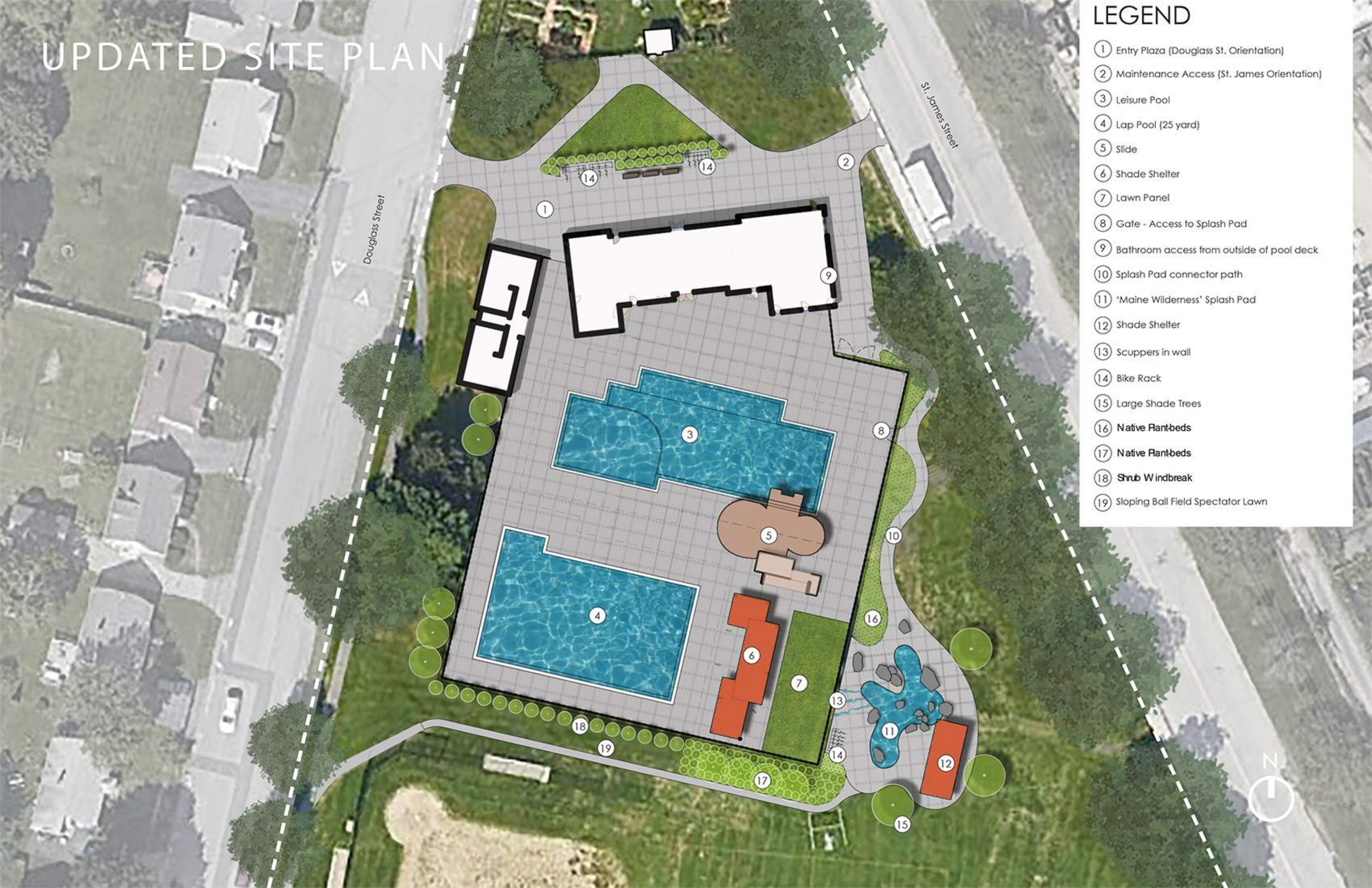

PROPOSED FLOOR PLAN



LEGEND

- | | |
|----------------------------|-------------------|
| 1. ENTRANCE | 5. POOL / DECK |
| 2. LOCKER ROOM / RESTROOM | 6. SUPPORT |
| 3. AD MIN. (PUBLIC FACING) | 7. STORAGE |
| 4. ADMIN. (BACK OF HOUSE) | 8. MECH / UTILITY |



VIEW FROM DOUGLAS STREET



VIEW OF ENTRY / LOCKER ROOMS FROM POOL DECK



VIEW OF POOL DECK FROM ENTRY / LOCKER ROOMS



VIEW OF SPLASHPAD



NATIVE PLANTINGS

EXISTING TREES

BUTTONS THAT CORRESPOND TO FOUNTAIN TIMERS

SEATING FOR ADULTS TO ENJOY PUTTING THEIR FEET IN THE WATER

DETAILS OF POOL / SPLASHPAD PLAY FEATURES



SOAKER



SLIDES



PLAY STONES



GEYSER



WATERFALL

UPDATED SITE PLAN

LEGEND

- ① Entry Plaza (Douglass St. Orientation)
- ② Maintenance Access (St. James Orientation)
- ③ Leisure Pool
- ④ Lap Pool (25 yard)
- ⑤ Slide
- ⑥ Shade Shelter
- ⑦ Lawn Panel
- ⑧ Gate - Access to Splash Pad
- ⑨ Bathroom access from outside of pool deck
- ⑩ Splash Pad connector path
- ⑪ 'Maine Wilderness' Splash Pad
- ⑫ Shade Shelter
- ⑬ Scuppers in wall
- ⑭ Bike Rack
- ⑮ Large Shade Trees
- ⑯ Native Plantbeds
- ⑰ Native Plantbeds
- ⑱ Shrub Windbreak
- ⑲ Sloping Ball Field Spectator Lawn

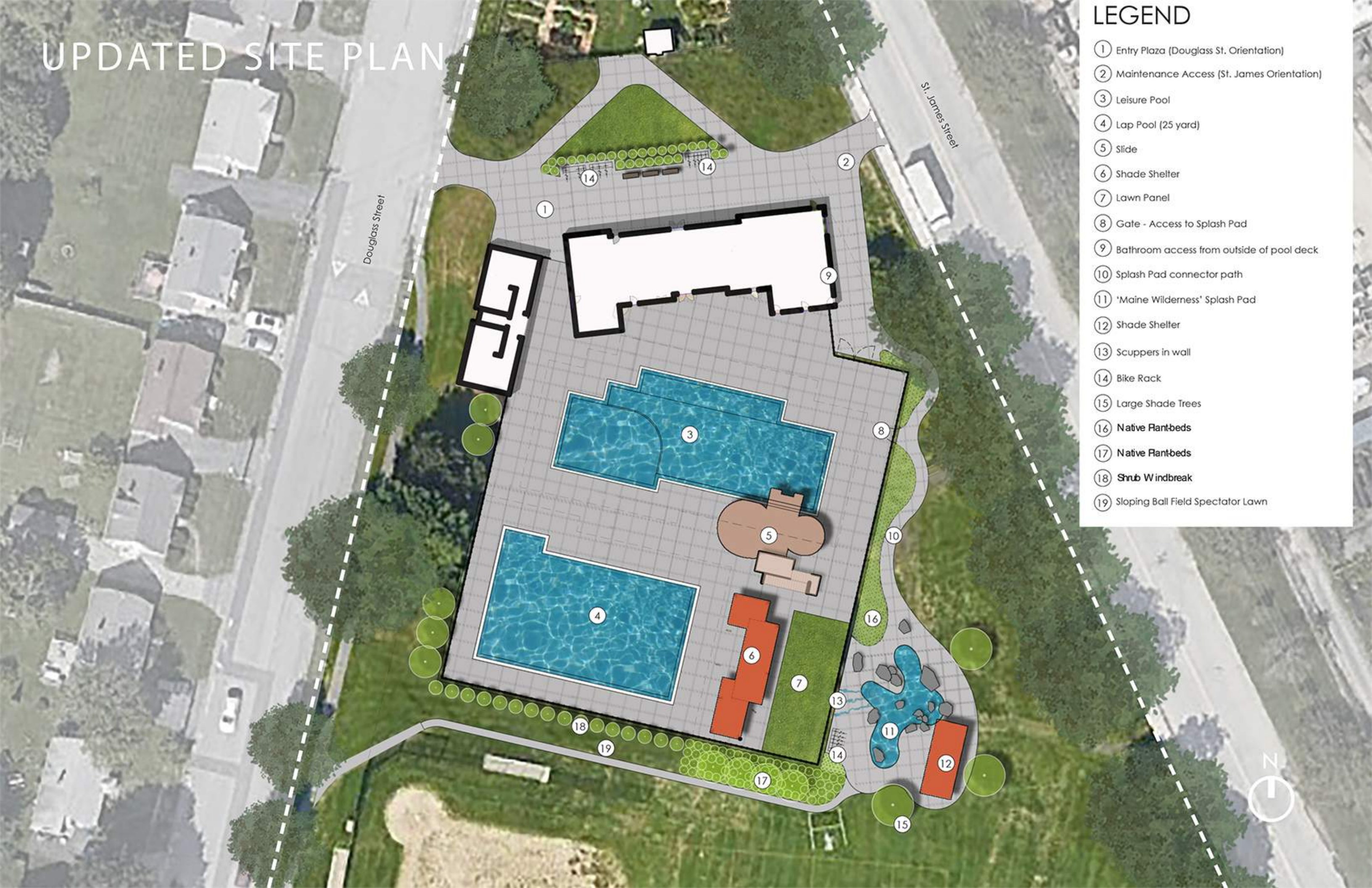

City of
portland



THANK YOU!

SCAN THE
QR CODE TO
SEE MORE
INFORMATION



Counsilman · Hunsaker
AQUATICS FOR LIFE