

OVERALL FIRST FLOOR PLAN

1/8" = 1'-0"

GENERAL NOTES - FLOOR PLANS:

- RE: SHEET CS-2 FOR ADDITIONAL GENERAL NOTES THAT ARE APPLICABLE.
- ARCHITECTURAL ELEVATION 0'-0" = CIVIL ELEVATION F.F.E.
- LEVEL HEIGHTS ARE TO T.O. SUBFLOOR.
- EXTERIOR DIMENSIONS SHOWN ON THE FLOOR PLAN ARE TO THE FACE OF STUD (FOS) AND COLUMN GRID LINES, UNLESS NOTED OR SHOWN OTHERWISE. INTERIOR DIMENSIONS ARE TO FACE OF STUD UNLESS NOTED OTHERWISE. NOTE: WALL THICKNESSES ARE ACTUAL DIMENSIONS.
- DOOR OPENINGS NOT LOCATED BY DIMENSION SHALL BE CENTERED IN WALL SHOWN OR LOCATED 4 INCHES FROM FINISH WALL TO HINGE SIDE OF THE DOOR, ALWAYS ALLOWING A MINIMUM OF 18" FROM THE PULL SIDE (STRIKE SIDE) OF THE DOOR TO THE INTERSECTING WALL, OR OTHER PROTRUDING OBJECTS.
- ALL PUBLIC SPACES: THE WALLS WILL BE FINISHED WITH 5/8" GYP. BD. TO A LEVEL 4 FINISH AND PAINTED, UNLESS NOTED OR SPECIFIED OTHERWISE.
- RE: FINISH LEGEND, FINISH SCHEDULE AND SPECIFICATIONS FOR DOOR AND DOOR FRAME FINISHES.
- FOR GUEST ROOM LAYOUTS AND DIMENSIONS, RE: SHEETS A1.21 - A1.23.
- PROVIDE 1 1/2" x 1 1/2" FULL HEIGHT MECHANICALLY FASTENED PLASTIC CORNER GUARDS AT ALL EXPOSED CORNERS.
- THE LOCATION OF WALL MOUNTED ELECTRICAL DEVICES INCLUDING RECEPTACLES, SWITCHES, LIGHT FIXTURES, DATA, CABLE, AND TELEPHONE BOXES SHALL BE COORDINATED TO ACCOMMODATE THE BUILT-IN FURNITURE AND SHALL BE IN COMPLIANCE WITH APPROPRIATE CODES. DEVICE BOXES SHALL NOT BE LOCATED BACK TO BACK IN THE SAME STUD CAVITY.

**DIXI DESIGN**  
 BUILDING DESIGN  
 1231 N. CACTUS AVE. SUITE "E" RIALTO, CA 92376  
 CREATIVE DEVELOPMENT & QUALITY  
 (909) 549-5563  
 LUIS A. SERRANO

REVISIONS

NO.	DESCRIPTION

SUBMITTAL



MICROTEL INN AND SUITES  
 81 ROOMS, 4-STORY  
 35,365.00 SQ.FT

APPLICANT / OWNER  
 SA GOLDEN INVESTMENT INC.  
 3610 W. RAMSEY ST.  
 BANNING, CA 92220  
 537-090-038,  
 039, 040, 041 & 042  
 A.P.N.

PLAN NAME  
**OVERALL 1ST FLOOR PLAN**

SHEET No.  
**A-2**

SCALE  
 AS SHOWN  
 DATE PLOT  
 1/22

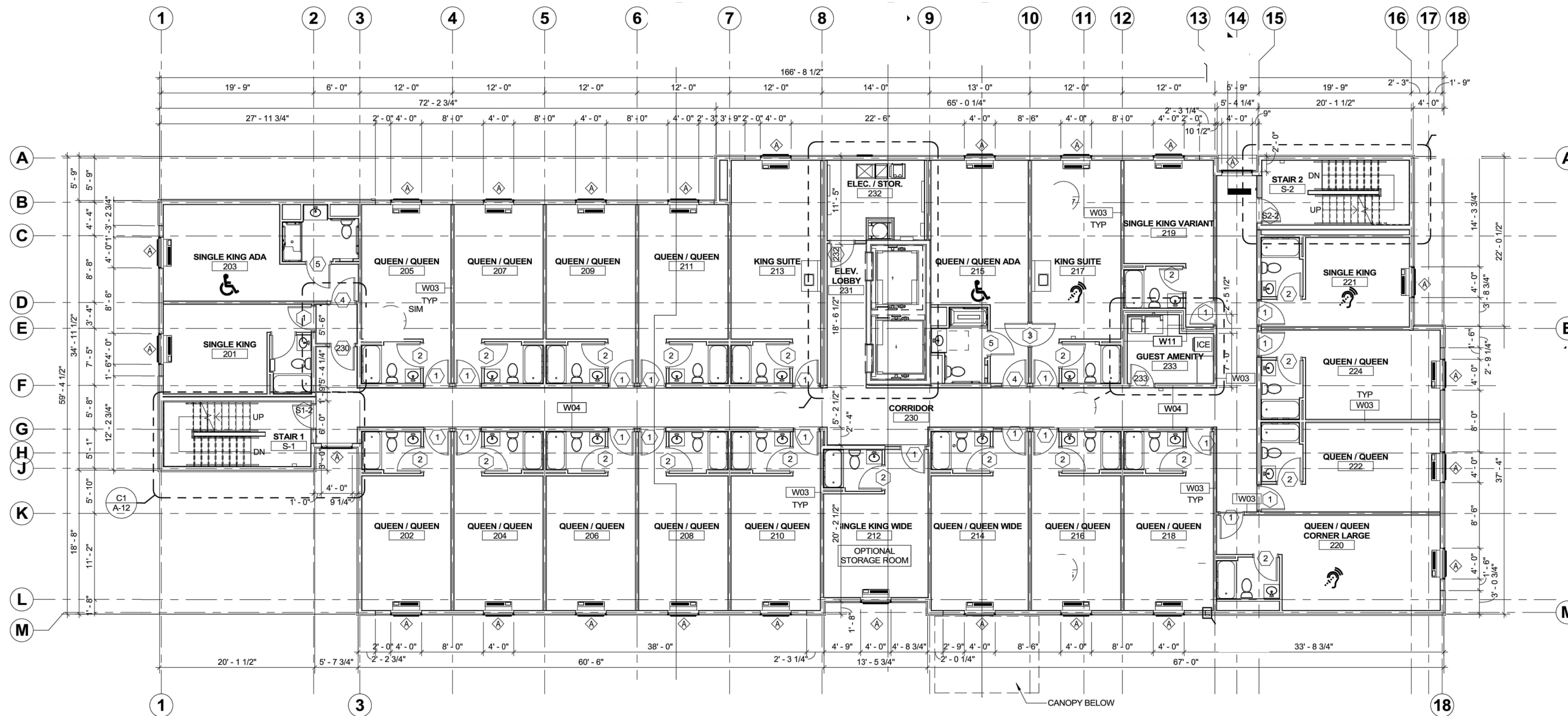

OVERALL SECOND, THIRD & FOURTH FLOOR PLAN  
 1/8" = 1'-0"

GENERAL NOTES - FLOOR PLANS:

- RE: SHEET CS-2 FOR ADDITIONAL GENERAL NOTES THAT ARE APPLICABLE.
- ARCHITECTURAL ELEVATION 0'-0" = CIVIL ELEVATION F.F.E.
- LEVEL HEIGHTS ARE TO T.O. SUBFLOOR.
- EXTERIOR DIMENSIONS SHOWN ON THE FLOOR PLAN ARE TO THE FACE OF STUD (FOS) AND COLUMN GRID LINES, UNLESS NOTED OR SHOWN OTHERWISE. INTERIOR DIMENSIONS ARE TO FACE OF STUD UNLESS NOTED OTHERWISE.
- NOTE: WALL THICKNESSES ARE ACTUAL DIMENSIONS.
- DOOR OPENINGS NOT LOCATED BY DIMENSION SHALL BE CENTERED IN WALL SHOWN OR LOCATED 4 INCHES FROM FINISH WALL TO HINGE SIDE OF THE DOOR, ALWAYS ALLOWING A MINIMUM OF 18" FROM THE PULL SIDE (STRIKE SIDE) OF THE DOOR TO THE INTERSECTING WALL, OR OTHER PROTRUDING OBJECTS.
- ALL PUBLIC SPACES: THE WALLS WILL BE FINISHED WITH 5/8" GYP. BD. TO A LEVEL 4 FINISH AND PAINTED, UNLESS NOTED OR SPECIFIED OTHERWISE.
- RE: FINISH LEGEND, FINISH SCHEDULE AND SPECIFICATIONS FOR DOOR AND DOOR FRAME FINISHES.
- FOR GUESTS ROOM LAYOUTS AND DIMENSIONS, RE: SHEETS A1.21 - A1.23.
- PROVIDE 1 1/2" x 1 1/2" FULL HEIGHT MECHANICALLY FASTENED PLASTIC CORNER GUARDS AT ALL EXPOSED CORNERS.
- THE LOCATION OF WALL MOUNTED ELECTRICAL DEVICES INCLUDING RECEPTACLES, SWITCHES, LIGHT FIXTURES, DATA, CABLE, AND TELEPHONE BOXES SHALL BE COORDINATED TO ACCOMMODATE THE BUILT-IN FURNITURE AND SHALL BE IN COMPLIANCE WITH APPROPRIATE CODES. DEVICE BOXES SHALL NOT BE LOCATED BACK TO BACK IN THE SAME STUD CAVITY.

**DIXI DESIGN**  
 DESIGNER:  
 BUILDING DESIGN  
 1231 N. CACTUS AVE SUITE 'E' RIALTO, CA 92376  
 CREATIVE DEVELOPMENT & QUALITY  
 (909) 549-5563  
 LUIS A. SERRANO

REVISIONS

NO.	DESCRIPTION

SUBMITTAL

**MICROTEL**  
 INN & SUITES  
 BY WYNDHAM  
 MICROTEL INN AND SUITES  
 81 ROOMS, 4-STORY  
 35,365.00 SQ.FT.  
 SCOPE OF WORK

APPLICANT / OWNER:  
 SA GOLDEN INVESTMENT INC.  
 3610 W. RAMSEY ST.  
 BANNING, CA. 92220  
 537-090-038,  
 039, 040, 041 & 042  
 A.P.N.

PLAN NAME  
 OVERALL  
 SECOND, THIRD  
 & FOURTH  
 FLOOR PLAN

SHEET No.  
**A-3**

SCALE  
 AS SHOWN  
 DATE PLOT  
 1/22



