



SHENANDOAH VALLEY  
ANIMAL SERVICES  
CENTER

# ANIMAL SHELTER RENOVATION

MAY 23, 2023

# SITE ADVANTAGES



- Individual buildings allow separation of cats and dogs
- Mature trees on site provide shade for outdoor areas
- Existing walking trails, grassy areas and paved areas for animal exercise
- Separate areas for farm animal rescue
- Visibility and easy access will encourage visits by adopters and volunteers



# SITE PLAN

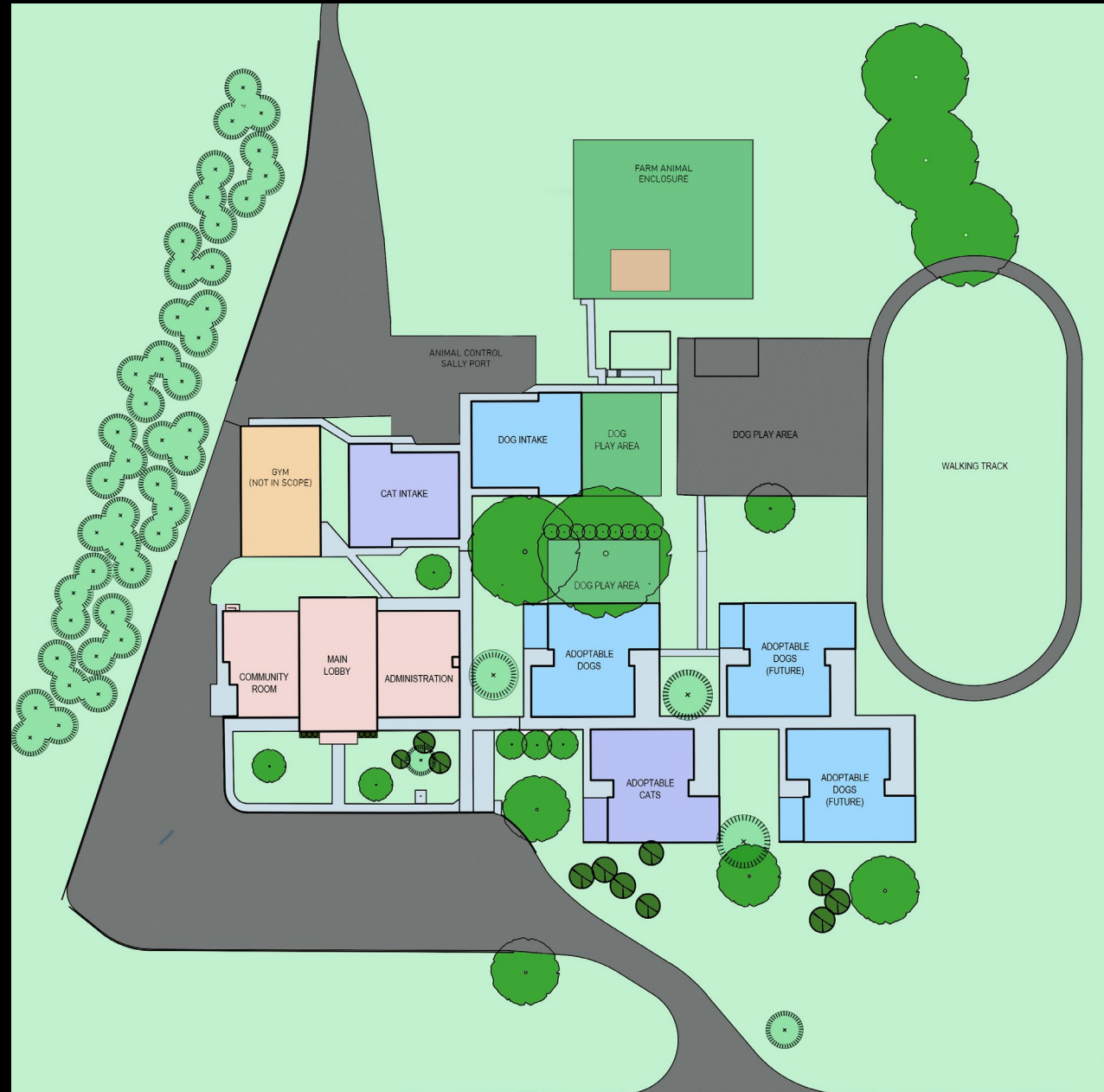

# EXISTING ENTRANCE

---



# STRATEGIES TO REDUCE ANIMAL STRESS

- Separate buildings for cats and dogs
- Walls and ceiling construction designed to reduce noise
- Fear –free interior design promotes calming colors
- Increased air flow reduces disease transmission
- Dimmable lighting in animal areas provide calming effect



# SHELTER CAPACITY OVER TIME

	# DOGS	TIME PERIOD	DOGS PER YEAR
CURRENT SHELTER	20	1 month	240
		(12 per year)	
NEW SHELTER	28	2 weeks	728
		(26 per year)	

	# CATS	TIME PERIOD	CATS PER YEAR
CURRENT SHELTER	18	1.5 month	144
		(8 per year)	
NEW SHELTER	66	1 month	792
		(12 per year)	



# NEW FRONT ENTRANCE

---



# ADMIN POD

- Welcoming lobby area
- Real life rooms for constant contact with animals
- Large training room to hold vaccine clinics, training and community events
- Dedicated areas for volunteers
- Separate intake entrance reduces disease
- Dedicated medical exam and grooming rooms
- Ample support and storage rooms



# ADMIN POD FLOOR PLAN



# FRONT LOBBY

---



# REAL LIFE PET ROOMS

---



# INTAKE PODS

- Separate buildings for dog intake and cat intake reduces stress on animals
- Double compartment kennels for stray dogs and court hold dogs
- Kennel design allows for double capacity in emergency situations
- Adjacent outdoor play yard for stray dogs
- Dedicated exam rooms for cat and dog intake areas
- Attendant areas for stray pod supervision of animals



# CAT INTAKE POD FLOOR PLAN



# DOG INTAKE POD FLOOR PLAN

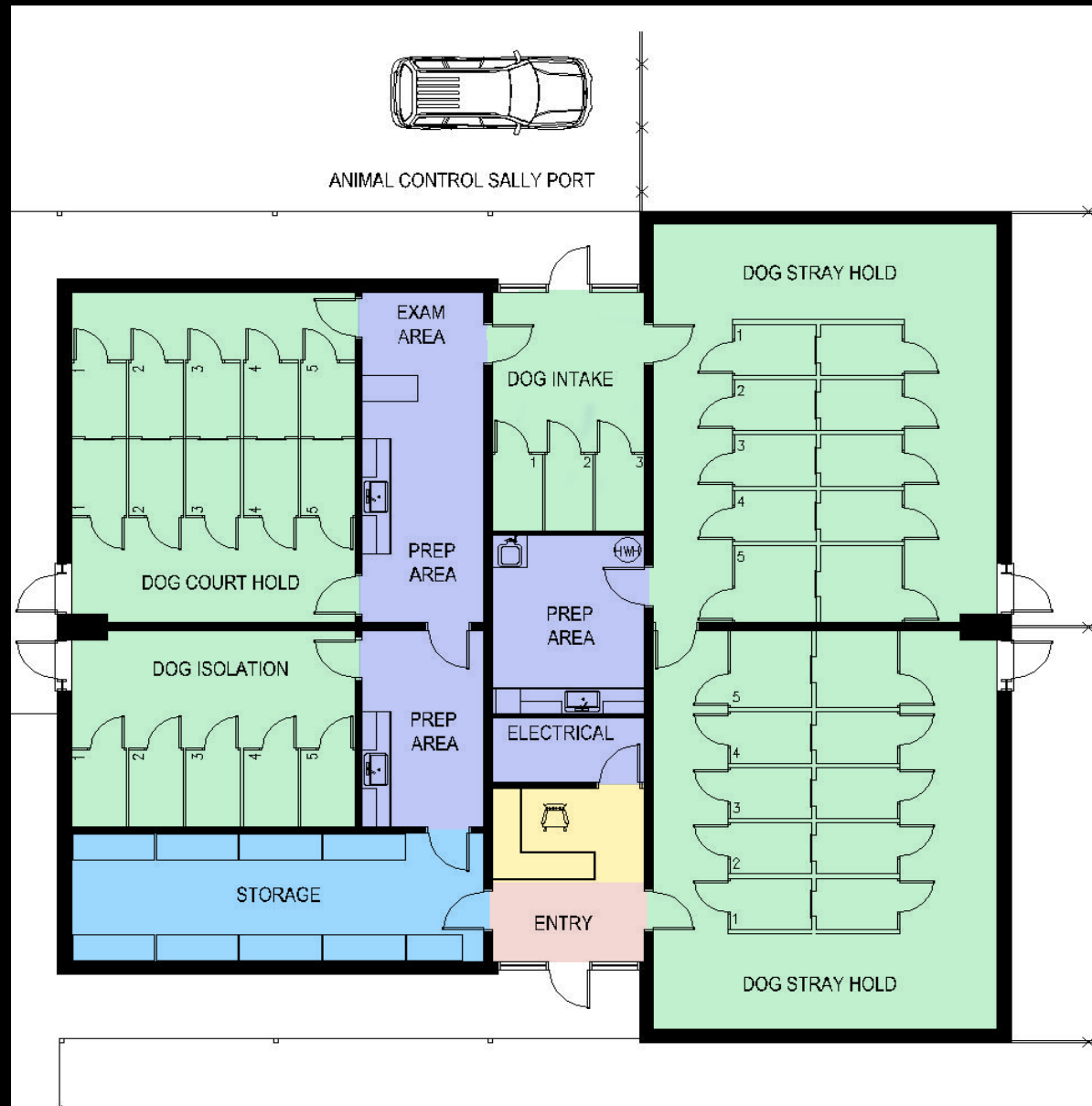

# ADOPTABLE CAT POD

- Community rooms, free roam areas and jumbo cage areas for less stress.
- Cages will contain portals to allow for separate sleeping and litter areas
- Minimum 11 sf per cat condo and 18 sf per cat in community rooms
- Two catios (outdoor cat patios)
- Separate kitten and small animal rooms



# ADOPTABLE CAT POD FLOOR PLAN

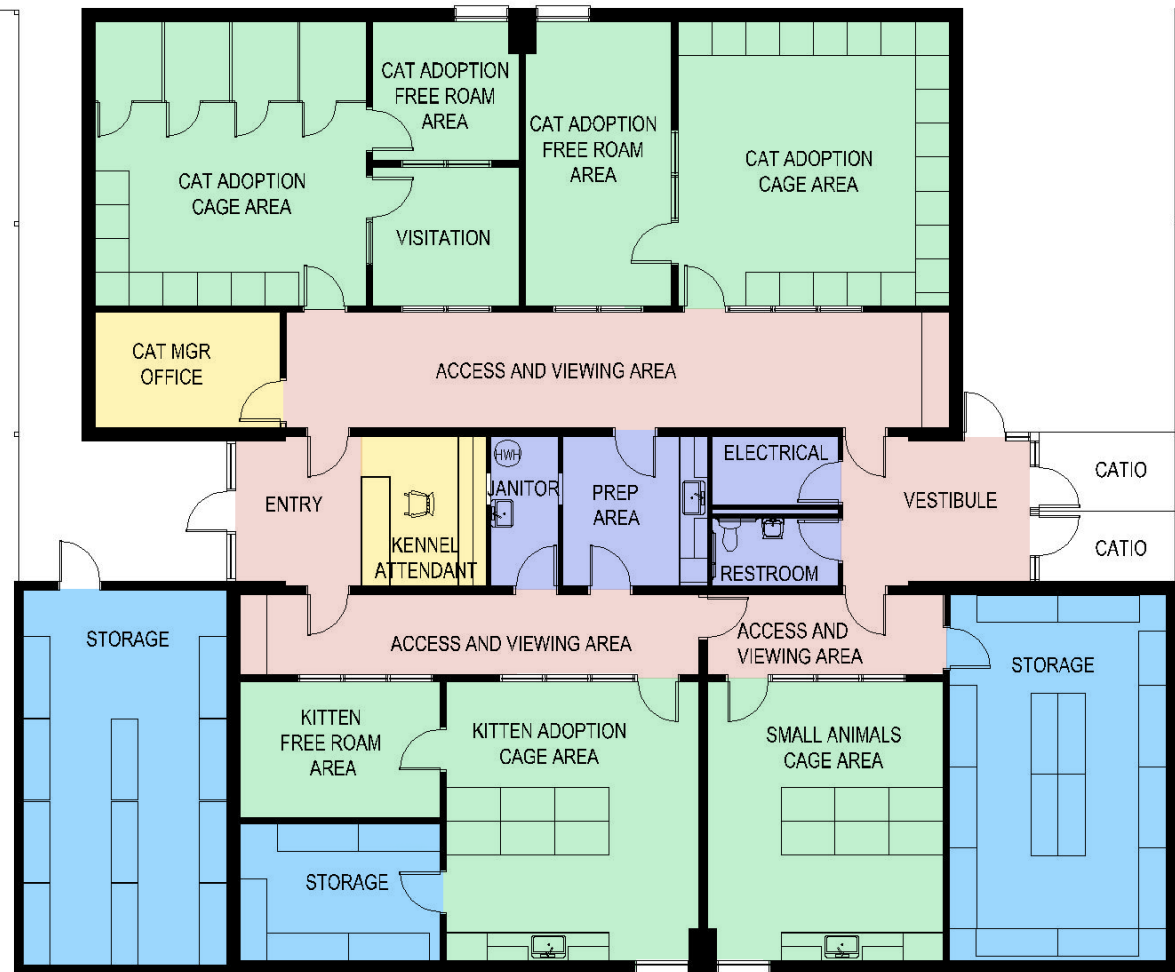

# ADOPTABLE CAT POD CONCEPTS

---



# ADOPTABLE DOG POD

- Multiple dog habitats including double runs, oversized runs, indoor/outdoor runs, real life rooms provide ample options to de-stress animals
- Double compartment kennels provide separate spaces for sleeping and eliminating (min 48 sf/dog)
- Visitation rooms
- Kennel attendant area for constant supervision
- Adjacent outdoor play yards
- In emergencies, dog capacity can be doubled by closing guillotine doors



# ADOPTABLE DOG POD FLOOR PLAN



# ADOPTABLE DOG POD KENNEL AREA

---



# ADOPTABLE DOG PLAY YARD

---



# FUTURE ADOPTABLE DOG POD #1 FLOOR PLAN



# FUTURE ADOPTABLE DOG POD #2 FLOOR PLAN

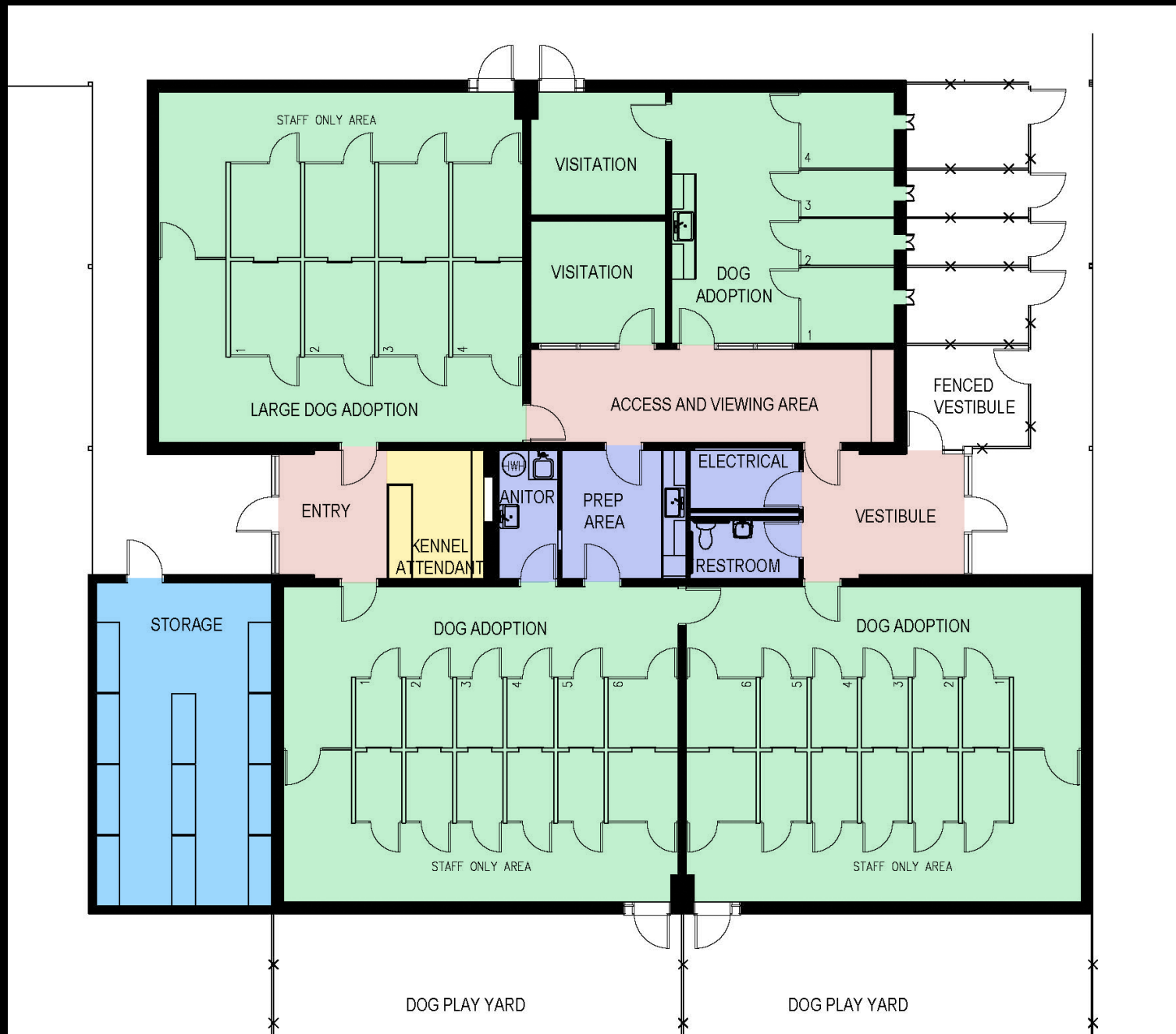

# SHELTER CAPACITY

LOCATION	STANDARD CAPACITY			EMERGENCY CAPACITY		
	CATS	DOGS	OTHER	CATS	DOGS	OTHER
ADMINISTRATION POD	2	4		4	8	
CAT INTAKE POD	44		9	88		18
DOG INTAKE POD		23			38	
ADOPTABLE CAT POD	66		9	123		18
ADOPTABLE DOG POD		28			48	
FUTURE ADOPTABLE DOG POD		24			40	
FUTURE ADOPTABLE DOG POD		24			40	
<b>FULL CAPACITY</b>	<b>112</b>	<b>103</b>	<b>18</b>	<b>215</b>	<b>174</b>	<b>36</b>
<b>INITIAL CAPACITY</b>	<b>112</b>	<b>55</b>	<b>18</b>	<b>215</b>	<b>94</b>	<b>36</b>



## **NEXT STEPS**

- FINAL DESIGN DOCUMENTS:
  - Fall 2023
- PROJECT BID:
  - Winter 2024
- CONSTRUCTION START:
  - Winter 2024
- CONSTRUCTION COMPLETE:
  - Fall 2024





**THANK YOU.**

Lineage Architects, P.C.  
98 Lee Highway  
Verona, VA 24482

[info@lineagearch.com](mailto:info@lineagearch.com)  
540-248-3771

**LINEAGE**  
ARCHITECTS • ENGINEERS • SURVEYORS