

LEGEND

- 5/8" CAPPED REBAR (NEW) RLS # 2712
- 5/8" CAPPED REBAR (OLD) "SOUTHERN STATES SURVEY"
- ⊙ 3/8" CAPPED REBAR (OLD) RLS # 105
- ◆ 3/4" UNCAPPED REBAR (OLD)
- ◇ 1/2" UNCAPPED REBAR (OLD)
- ⊙ SANITARY SEWER MANHOLE
- ⊕ 3/4" IRON PIPE (OLD)
- ⊕ 1/2" IRON PIPE (OLD)
- ⊕ 1.5" IRON PIPE (OLD)
- ⊕ 1" IRON PIPE (OLD)
- ⊕ 1" IRON ROD (OLD)
- ▲ CONTROL POINT
- ◆ FIRE HYDRANT
- ⊕ POWER POLE
- X — FENCE
- W — WATER LINE
- E — OVERHEAD ELECTRIC
- SS — SANITARY SEWER LINE
- — — EDGE OF GRAVEL
- — — PROPERTY BOUNDARY
- ⊕ CONCRETE

LINE	BEARING	DISTANCE
L1	S 60°31'40" W	177.11'
L2	N 89°10'59" E	136.65'
L3	S 85°27'27" E	59.56'

CURVE	RADIUS	ARC LENGTH	CHORD LENGTH	CHORD BEARING	DELTA ANGLE
G1	101.31'	12.46'	12.45'	S 69°49'51" W	17°02'48"

MOORE
LAND SURVEYS
208 N. CHANCERY ST.
MCMINNVILLE, TN
931.473.1088
MICHAEL@
MOORELANDSURVEYS.COM

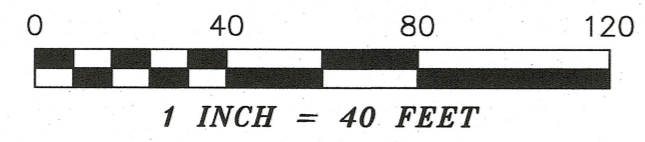

NOTE: This survey was performed with RTK GPS positional data observed on the date of 2-2-2024 utilizing a Topcon HiPer HR dual frequency receiver. The grid coordinates of the control point shown were derived using a VRS network of CORS stations projected to TN SPC83; Datum: NAD 83; Geoid: ContinentalUS_NGS2018. The positional accuracy of the GPS vectors does not exceed H: 5 mm + 0.5 ppm, V: 10 mm + 0.8 ppm. The combined grid factor used for this survey is 0.99991055 centered upon the control point shown hereon.

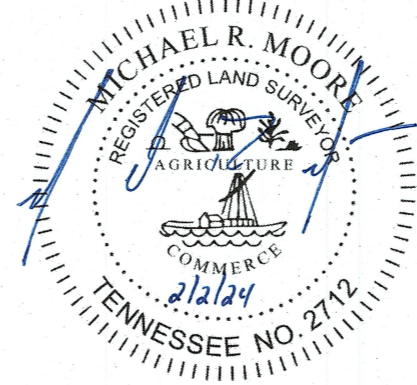

SURVEYOR'S CERTIFICATE
I hereby certify, to the best of my knowledge and belief, that the survey shown hereon represents a Category IV Survey and is in compliance with the current Tennessee Minimum Standards of Practice.
Date: 2/2/24
Registered Land Surveyor

BOBBY RAY ELEMENTARY

DRAWN BY	DATE	504 N Chancery St
EHJ	2/2/24	McMinnville, TN 37110
Tax ID: 059M H 027.00		Warren County
		1st Civil District
SCALE	ACREAGE	PROJECT NO.
1" = 40'	5.27 AC.±	24024

DEED REFERENCES:
DEED BOOK 168 - PAGE 577
DEED BOOK 174 - PAGE 613
P/O DEED BOOK 118 - PAGE 573
P/O DEED BOOK 134 - PAGE 190
P/O DEED BOOK 171 - PAGE 813