

FREEDOM PARK PICKLEBALL COURTS

CITY OF EDGEWOOD KENTON COUNTY, KENTUCKY

FREEDOM PARK DRIVE
EDGEWOOD, KENTUCKY 41017
JOB #231224

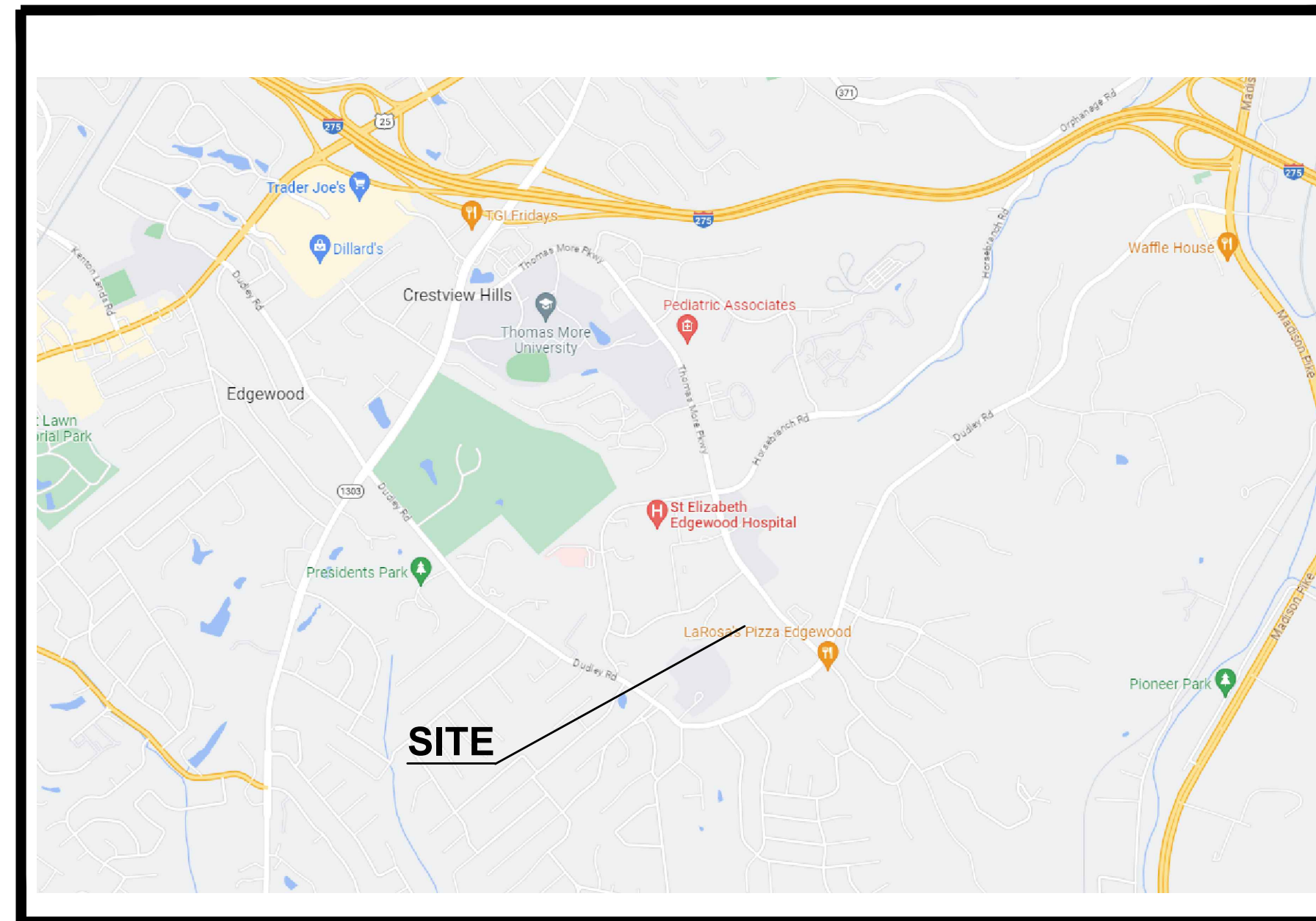

VICINITY MAP

| CITY OF EDGEWOOD OFFICIALS |
|---|
| MAYOR JOHN LINK |
| CITY CLERK BELINDA NITSCHKE |
| CITY ADMINISTRATOR BRIAN DEHNER |
| CITY COUNCIL MEMBERS BEN BARLAGE DARLA KETTENACKER JOE MESSMER JEFF SCHREIVER SCOTT SPILLE ROB THELEN KIM WOLKING |
| CITY ATTORNEY FRANK WICHMANN |
| PUBLIC WORKS DIRECTOR RICK LUNNEMANN |

| INDEX OF SHEETS | | |
|-----------------|----------|-------------------------------------|
| NO. | DWG NAME | SHEET NAME |
| 1 | C1 | TITLE |
| 2 | C2 | NOTES & LEGEND |
| 3 | C3 | EXISTING CONDITIONS/DEMO SHEET |
| 4 | C4 | SITE LAYOUT - BASE OPTION |
| 5 | C5 | SITE LAYOUT - ALTERNATE OPTION |
| 6 | C6 | UTILITY LAYOUT SHEET |
| 7 | C7 | GRADING & EROSION CONTROL SHEET |
| 8 | C8 | DETAIL SHEET 1 |
| 9 | C9 | DETAIL SHEET 2 |
| 10 | C10 | STORMWATERPOLLUTION PREVENTION PLAN |

| ZONING INFORMATION |
|--|
| OWNER: CITY OF EDGEWOOD |
| PROPERTY ADDRESS: FREEDOM PARK DRIVE |
| PARCEL NUMBER: 029-20-00-001.10 |
| DB/PAGE: BOOK 1155, PAGE 4 |
| TOTAL ACREAGE: 10.49 ACRES |
| ACREAGE DISTURBED: 0.4386 ACRES |
| CURRENT ZONING: INSTITUTIONAL - TWO (INST-2) ZONE |
| PROPOSED USE: RECREATION |
| SETBACKS: MINIMUM FRONT, SIDE, AND REAR YARD SETBACKS - TWENTY-FIVE (25) FEET, EXCEPT AS PROVIDED IN THE FOLLOWING: a. WHERE ANY FRONT, SIDE, OR REAR YARD OF ANY USE PERMITTED IN THIS ZONE ABUTS A RESIDENTIAL ZONE, A MINIMUM YARD REQUIREMENT OF NINETY (90) FEET SHALL BE PROVIDED, FIFTY (50) FEET OF WHICH SHALL BE MAINTAINED BY A SCREENING AREA, AS REGULATED BY SECTION 9.17 OF THIS ORDINANCE. THIS 50 FOOT AREA SHALL REMAIN OPEN AND NOT PERMIT OFF-STREET PARKING AND LOADING AND/OR UNLOADING. IN THE EVENT THAT SUCH SCREENING AREA CONTAINS AN EARTHEN BERM OR MOUND AT LEAST SIX (6) FEET IN HEIGHT, THE FIFTY (50) FOOT SCREENING AREA SHALL BE REDUCED TO THIRTY (30) FEET. b. WHERE ANY FRONT, SIDE, OR REAR YARD OF ANY USE PERMITTED IN THIS ZONE IS ADJACENT TO AN ARTERIAL OR COLLECTOR STREET, AS IDENTIFIED IN THE ADOPTED COMPREHENSIVE PLAN, A MINIMUM YARD REQUIREMENT OF SIXTY (60) FEET SHALL BE PROVIDED. |

| BENCHMARK INFORMATION |
|---|
| BM1: SCIPS VRS NORTH = 549836.066 EAST = 1553087.346 ELEVATION = 846.341 |
| BM2: SCIPS VRS NORTH = 549865.953 EAST = 1552921.182 ELEVATION = 844.415 |

PROJECT SPECIFICATIONS
THE LATEST STANDARD SPECIFICATIONS OF THE KENTUCKY TRANSPORTATION CABINET, INCLUDING CHANGES AND SUPPLEMENTAL SPECIFICATIONS THERETO, AND THE CITY OF EDGEWOOD ENGINEERING DEPARTMENT SHALL GOVERN THIS PROJECT.

SOURCE OF BOUNDARY INFORMATION
THE BOUNDARY INFORMATION SHOWN ON THESE PLANS IS BASED UPON KENTON COUNTY G.I.S. MAPPING AND DOES NOT REPRESENT AN ACTUAL FIELD BOUNDARY SURVEY BY CT CONSULTANTS, INC.

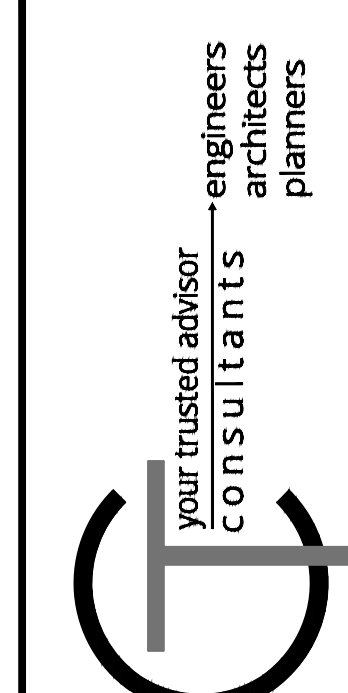

| DATE | REVISION | NO | REVIEW | ISSUED FOR: | ISSUE DATE: | SCALE: | DESIGNED BY: | DRAWN BY: | CHECKED BY: |
|------|----------|----|--------|-------------|-------------|----------|--------------|-----------|-------------|
| | | | | | 07/13/23 | AS SHOWN | DGAR | DGAR | MHEL |

FREEDOM PARK PICKLEBALL COURTS
CITY OF EDGEWOOD
- KENTON COUNTY, KENTUCKY -

| | |
|------------------------------|-----------------|
| PROJECT NO. 231224 | |
| DISCIPLINE CIVIL | |
| SHEET NAME C1 | |
| SHEET 1 | OF 10 |

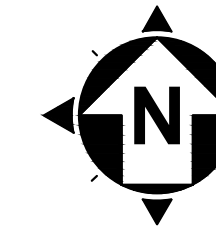

NORTH AND BEARING SYSTEM BASED ON NAD83 (2011) KENTUCKY STATE PLANE, NORTH ZONE, US FOOT

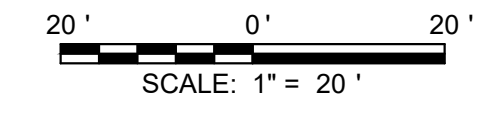

DEMOLITION NOTES

- 1 DO NOT DISTURB
- 2 REMOVE AND SALVAGE EX. BENCH FOR OWNERS USE. (INCIDENTAL TO CLEARING AND GRUBBING)
- 3 REMOVE AND SALVAGE EX. BLEACHERS FOR OWNERS USE. (INCIDENTAL TO CLEARING AND GRUBBING)
- 4 REMOVE EXISTING STORM SEWER INLET.

HATCH LEGEND

-  EXISTING PAVEMENT TO BE REMOVED
-  EXISTING TREE TO BE REMOVED

your trusted advisor
consultants

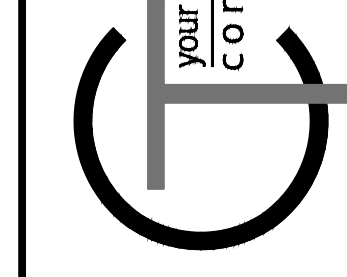

engineers
architects
planners

| ISSUED FOR: | REVIEW | NO | REVISION | DATE |
|----------------------|-------------------|----|----------|------|
| ISSUE DATE: 07/13/23 | AS SHOWN | | | |
| SCALE: | DESIGNED BY: DGAR | | | |
| | DRAWN BY: DGAR | | | |
| | CHECKED BY: MHIEL | | | |

FREEDOM PARK PICKLEBALL COURTS
CITY OF EDGEWOOD
- KENTON COUNTY, KENTUCKY -

EXISTING CONDITIONS AND DEMO PLAN SHEET

| | |
|-------------|--------|
| PROJECT NO: | 231224 |
| DISCIPLINE | CIVIL |
| SHEET NAME | C3 |
| SHEET | 3 |
| OF | 10 |



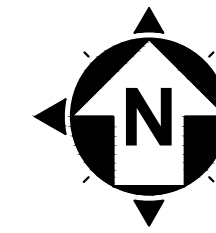

NORTH AND BEARING SYSTEM BASED ON NAD83 (2011) KENTUCKY STATE PLANE, NORTH ZONE, US FOOT

0' 20' 40'
SCALE: 1" = 20'

GENERAL CONSTRUCTION NOTES

- 1 DO NOT DISTURB
- 2 NOT USED
- 3 INSTALL PICKLEBALL POSTS AND NET PER DETAIL.
- 4 SAWCUT EXISTING PAVEMENT TO CREATE A CLEAN JOINT FOR THE PROPOSED ASPHALT WALK.
- 5 CONSTRUCT 6" WIDE CONCRETE PERIMETER CURB, FLUSH WITH COURT PAVEMENT.
- 6 PROPOSED BENCH (BY OTHERS)
- 7 6' TALL BLACK VINYL CHAIN LINK FENCE.

STORM SEWER CONSTRUCTION NOTES

- D1 EXTEND UNDERDRAIN OUTLET PIPE. 4" SOLID PVC.
- D2 CONNECT PROPOSED UNDERDRAIN OUTLET TO PROPOSED CATCH BASIN
- D3 CORE DRILL AND CONNECT PROPOSED STORM SEWER CONDUIT TO EXISTING CATCH BASIN.
- D4 INSTALL NYLOPLAST INLINE DRAIN FOR 8" PIPE OR APPROVED EQUAL.

ELECTRIC CONSTRUCTION NOTES

- E1 NOT USED

WATER CONSTRUCTION NOTES

- W1 ADJUST IRRIGATION BOX TO GRADE.

HATCH LEGEND

- ASPHALT PAVEMENT FOR COURTS - SEE DETAIL SHEET.
- ASPHALT WALKING PATH - SEE DETAIL SHEET.
- TO BE REMOVED

UTILITY STRUCTURE LEGEND

- 10 STORM SEWER STRUCTURE LABEL
- X10 EXISTING STORM SEWER STRUCTURE LABEL
- D-1 STORM SEWER PROFILE RUN
- A PR. SANITARY SEWER STRUCTURE LABEL
- X-A EX. SANITARY SEWER STRUCTURE LABEL
- S-1 SANITARY SEWER PROFILE RUN
- W-1 WATER PROFILE RUN
- G-1 GAS PROFILE RUN

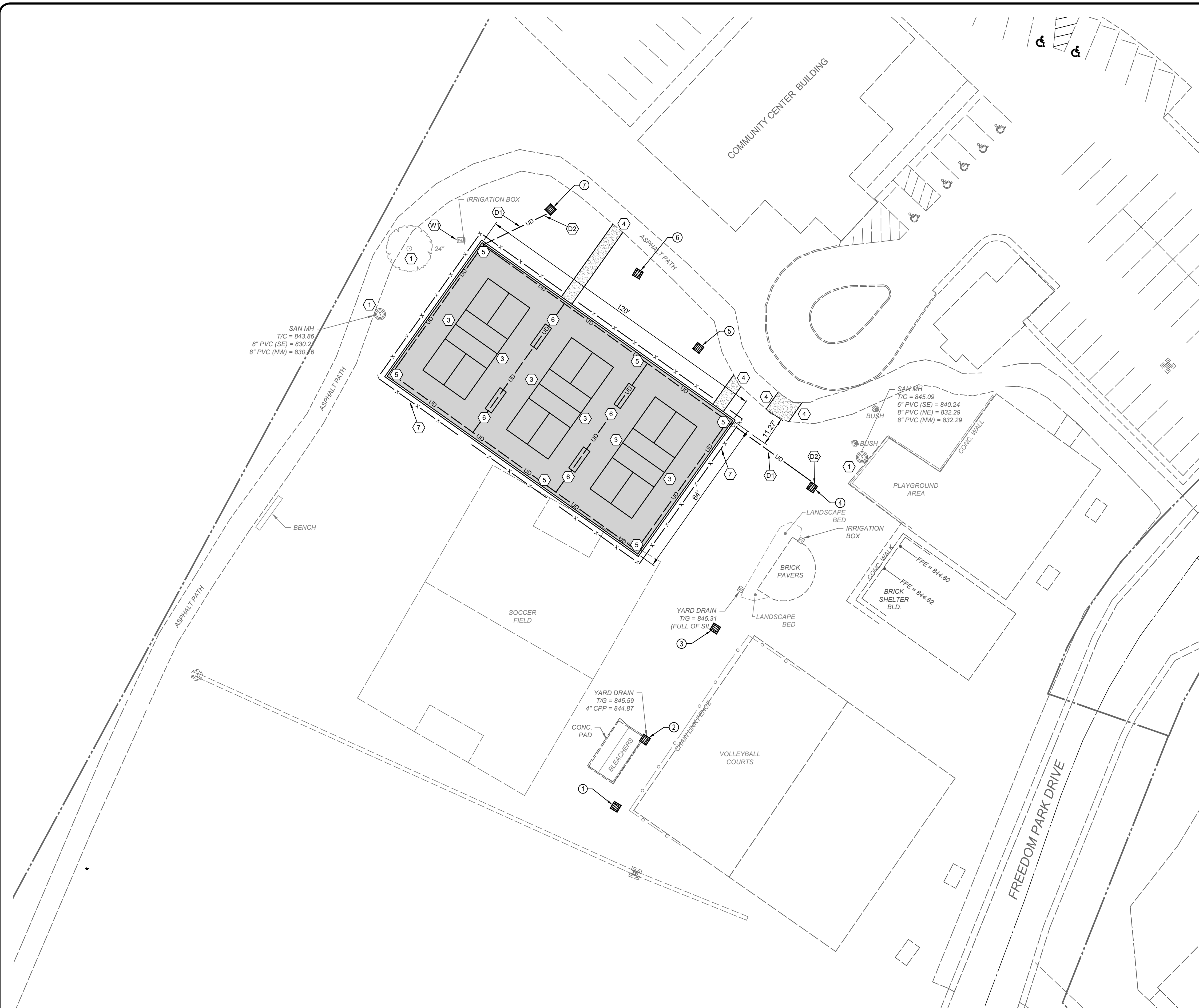

your trusted advisor
consultants
engineers
architects
planners

| ISSUED FOR: | REVIEW | NO | REVISION | DATE |
|--------------|----------|----|----------|------|
| 07/13/23 | AS SHOWN | | | |
| DESIGNED BY: | DGAR | | | |
| DRAWN BY: | DGAR | | | |
| CHECKED BY: | MHEL | | | |

FREEDOM PARK PICKLEBALL COURTS
CITY OF EDGEWOOD
- KENTON COUNTY, KENTUCKY -
SITE LAYOUT - BASE OPTION

| | |
|-------------|--------|
| PROJECT NO. | 231224 |
| DISCIPLINE | CIVIL |
| SHEET NAME | C4 |
| SHEET | 4 |
| OF | 10 |

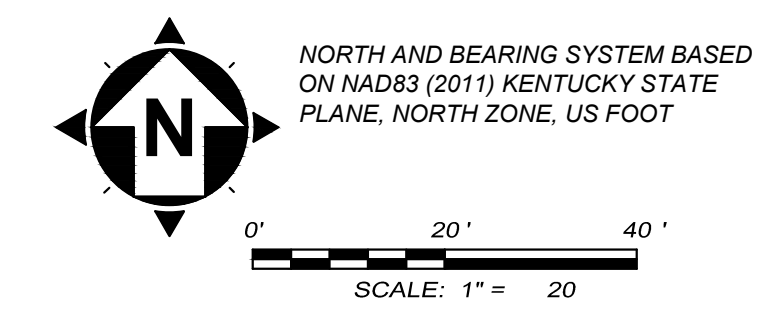

GENERAL CONSTRUCTION NOTES

- 1 DO NOT DISTURB
- 2 NOT USED
- 3 INSTALL PICKLEBALL POSTS AND NET PER DETAIL.
- 4 SAWCUT EXISTING PAVEMENT TO CREATE A CLEAN JOINT FOR THE PROPOSED ASPHALT WALK.
- 5 CONSTRUCT 6" WIDE CONCRETE PERIMETER CURB, FLUSH WITH COURT PAVEMENT.
- 6 PROPOSED BENCH (BY OTHERS)
- 7 6' TALL BLACK VINYL CHAIN LINK FENCE.

STORM SEWER CONSTRUCTION NOTES

- D1 EXTEND UNDERDRAIN OUTLET PIPE. 4" SOLID PVC.
- D2 CONNECT PROPOSED UNDERDRAIN OUTLET TO PROPOSED CATCH BASIN
- D3 CORE DRILL AND CONNECT PROPOSED STORM SEWER CONDUIT TO EXISTING CATCH BASIN.
- D4 INSTALL NYLOPLAST INLINE DRAIN FOR 8" PIPE OR APPROVED EQUAL.

ELECTRIC CONSTRUCTION NOTES

- E1 NOT USED

WATER CONSTRUCTION NOTES

- W1 ADJUST IRRIGATION BOX TO GRADE.

HATCH LEGEND

- ASPHALT PAVEMENT FOR COURTS - SEE DETAIL SHEET.
- ASPHALT WALKING PATH - SEE DETAIL SHEET.
- TO BE REMOVED

UTILITY STRUCTURE LEGEND

- 10 STORM SEWER STRUCTURE LABEL
- X10 EXISTING STORM SEWER STRUCTURE LABEL
- D-1 STORM SEWER PROFILE RUN
- A PR. SANITARY SEWER STRUCTURE LABEL
- X-A EX. SANITARY SEWER STRUCTURE LABEL
- S-1 SANITARY SEWER PROFILE RUN
- W-1 WATER PROFILE RUN
- G-1 GAS PROFILE RUN

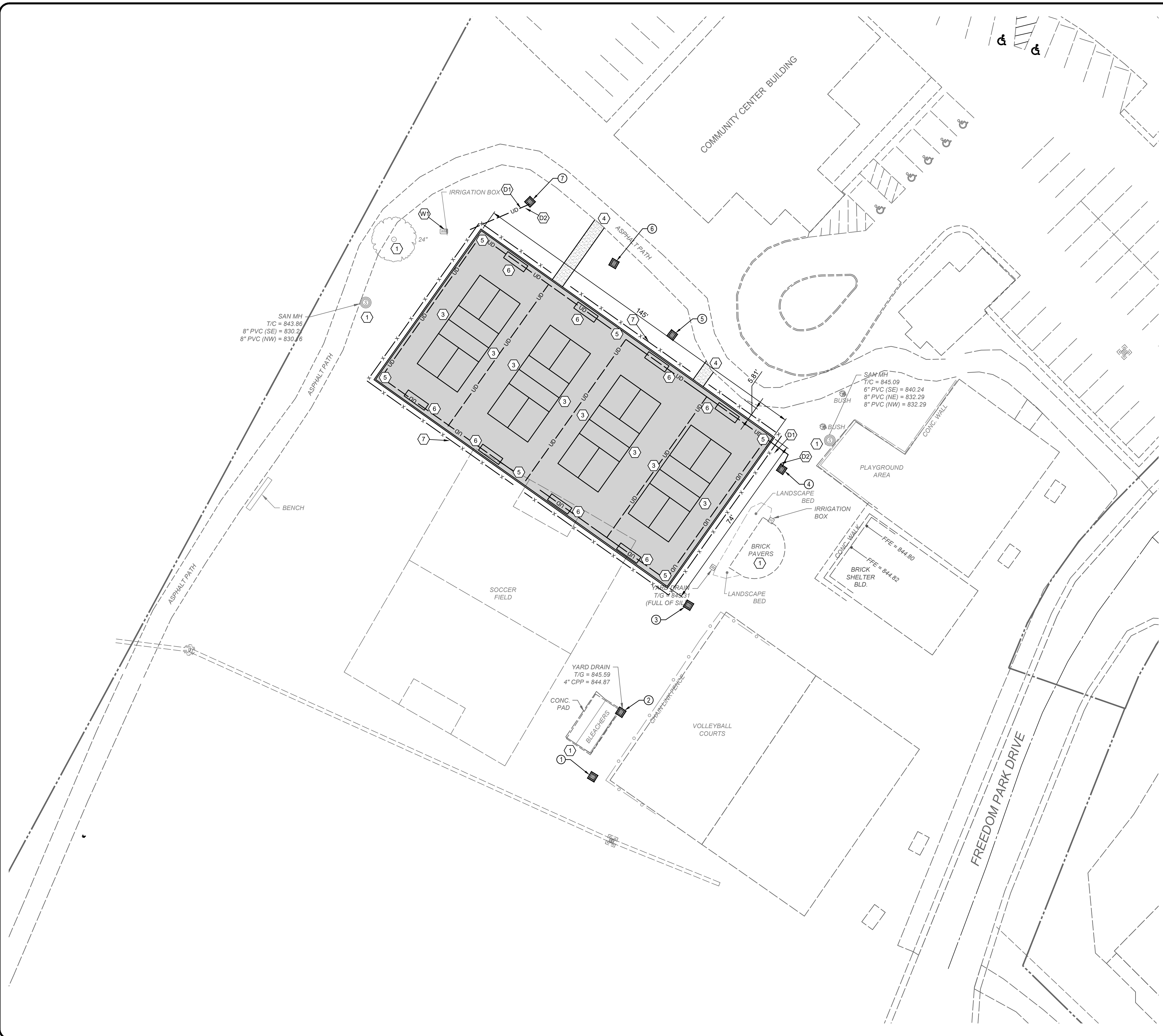

your trusted advisor
consultants
engineers
architects
planners

| ISSUED FOR: | REVIEW | NO | REVISION | DATE |
|--------------|----------|----|----------|------|
| 07/13/23 | AS SHOWN | | | |
| DESIGNED BY: | DGAR | | | |
| DRAWN BY: | DGAR | | | |
| CHECKED BY: | MHEL | | | |

FREEDOM PARK PICKLEBALL COURTS
CITY OF EDGEWOOD
- KENTON COUNTY, KENTUCKY -
SITE LAYOUT - ALTERNATE OPTION

| | |
|-------------|--------|
| PROJECT NO. | 231224 |
| DISCIPLINE | CIVIL |
| SHEET NAME | C5 |
| SHEET | OF |
| 5 | 10 |

OPTIONS NOTE

BOTH FOOTPRINT SHOWN FOR LIMITS ONLY.
SEE SITE SHEET FOR ACTUAL LAYOUT
DESIGN AND UTILITY DESIGN.

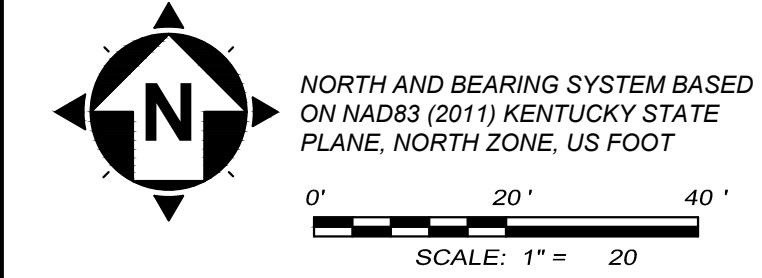
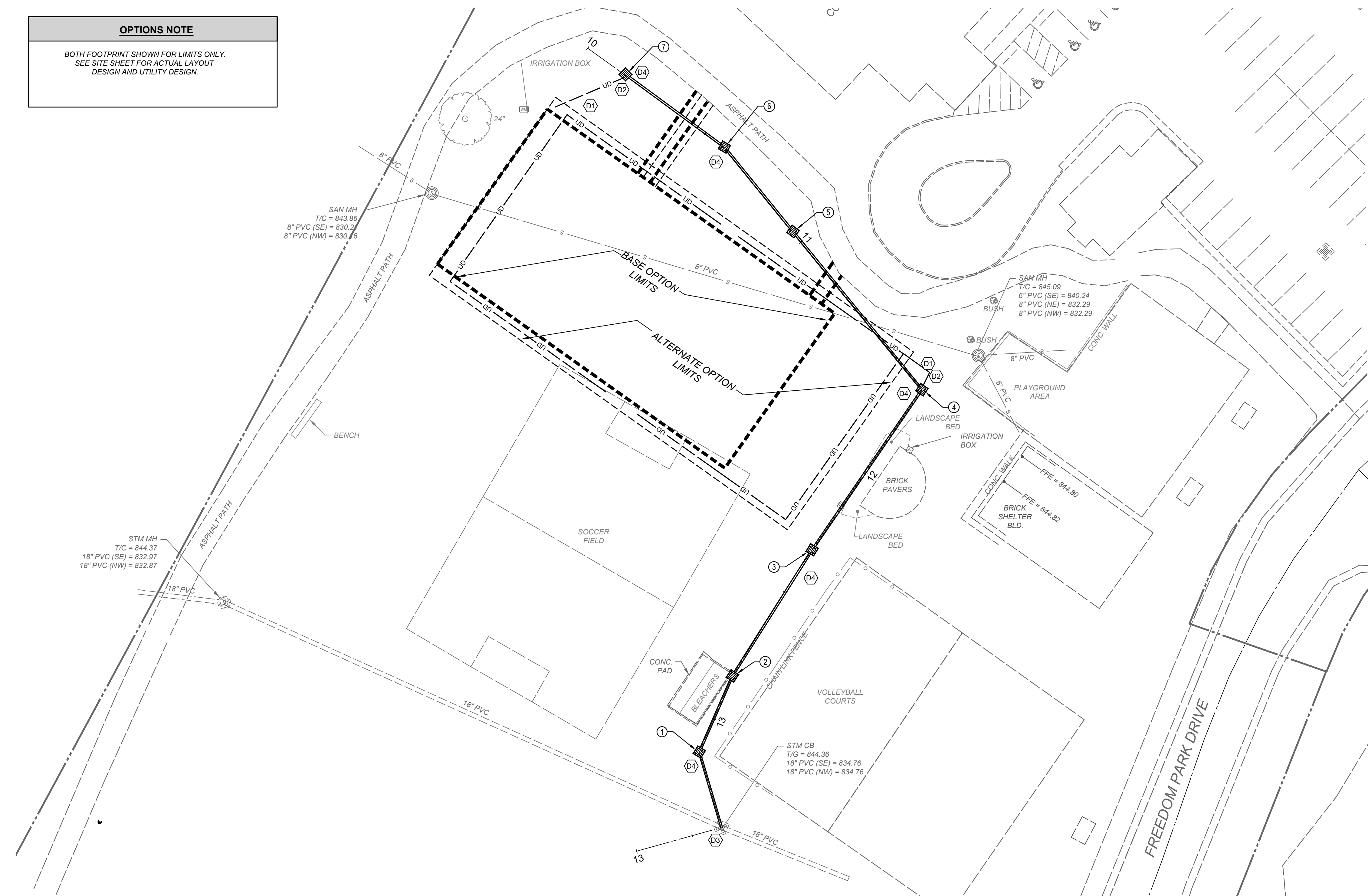

GENERAL CONSTRUCTION NOTES

- 1 DO NOT DISTURB
- 2 NOT USED
- 3 INSTALL PICKLEBALL POSTS AND NET PER DETAIL.
- 4 SAWCUT EXISTING PAVEMENT TO CREATE A CLEAN JOINT FOR THE PROPOSED ASPHALT WALK.
- 5 CONSTRUCT 6" WIDE CONCRETE PERIMETER CURB, FLUSH WITH COURT PAVEMENT.
- 6 PROPOSED BENCH (BY OTHERS)
- 7 6' TALL BLACK VINYL CHAIN LINK FENCE.

STORM SEWER CONSTRUCTION NOTES

- D1 EXTEND UNDERDRAIN OUTLET PIPE. 4" SOLID PVC.
- D2 CONNECT PROPOSED UNDERDRAIN OUTLET TO PROPOSED CATCH BASIN
- D3 CORE DRILL AND CONNECT PROPOSED STORM SEWER CONDUIT TO EXISTING CATCH BASIN.
- D4 INSTALL NYLOPLAST INLINE DRAIN FOR 8" PIPE OR APPROVED EQUAL.

ELECTRIC CONSTRUCTION NOTES

- E1 NOT USED

WATER CONSTRUCTION NOTES

HATCH LEGEND

- ASPHALT PAVEMENT FOR COURTS - SEE DETAIL SHEET.
- ASPHALT WALKING PATH - SEE DETAIL SHEET.
- TO BE REMOVED

UTILITY STRUCTURE LEGEND

- 10 STORM SEWER STRUCTURE LABEL
- X10 EXISTING STORM SEWER STRUCTURE LABEL
- D-1 STORM SEWER PROFILE RUN
- A PR. SANITARY SEWER STRUCTURE LABEL
- X-A EX. SANITARY SEWER STRUCTURE LABEL
- S-1 SANITARY SEWER PROFILE RUN
- W-1 WATER PROFILE RUN
- G-1 GAS PROFILE RUN

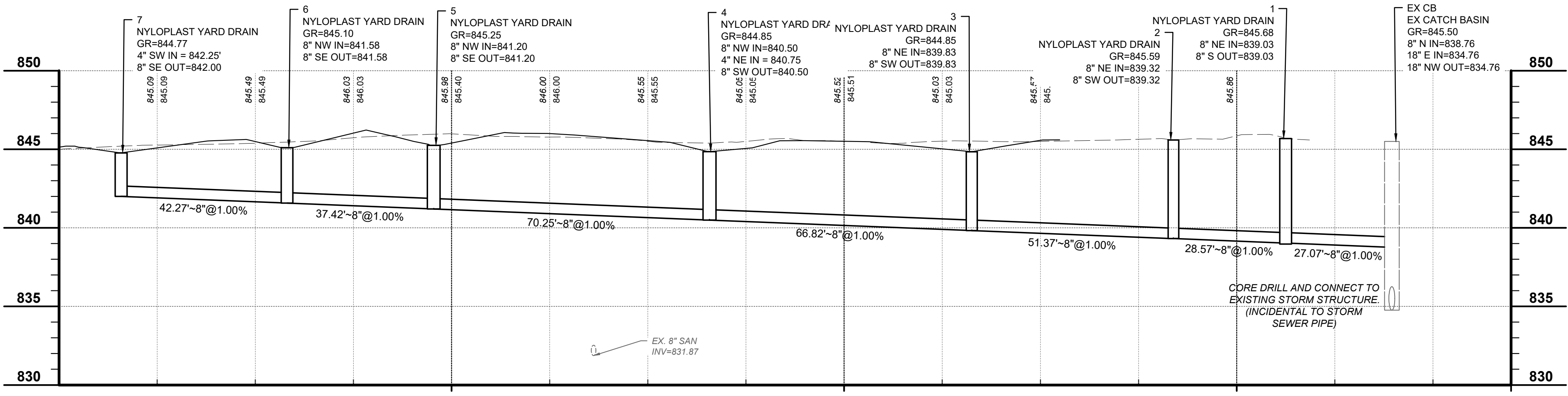

your trusted advisor
consultants
engineers
architects
planners

| ISSUED FOR: | REVIEW | NO | DATE |
|-------------|----------|----|------|
| AS SHOWN | 07/13/23 | | |

| DESIGNED BY: | DRAWN BY: | CHECKED BY: |
|--------------|-----------|-------------|
| DGAR | DGAR | MHEL |

FREEDOM PARK PICKLEBALL COURTS
CITY OF EDGEWOOD
- KENTON COUNTY, KENTUCKY -
SITE UTILITY PLAN

| | |
|-------------|--------|
| PROJECT NO. | 231224 |
| DISCIPLINE | CIVIL |
| SHEET NAME | C6 |
| SHEET | 6 |
| OF | 10 |

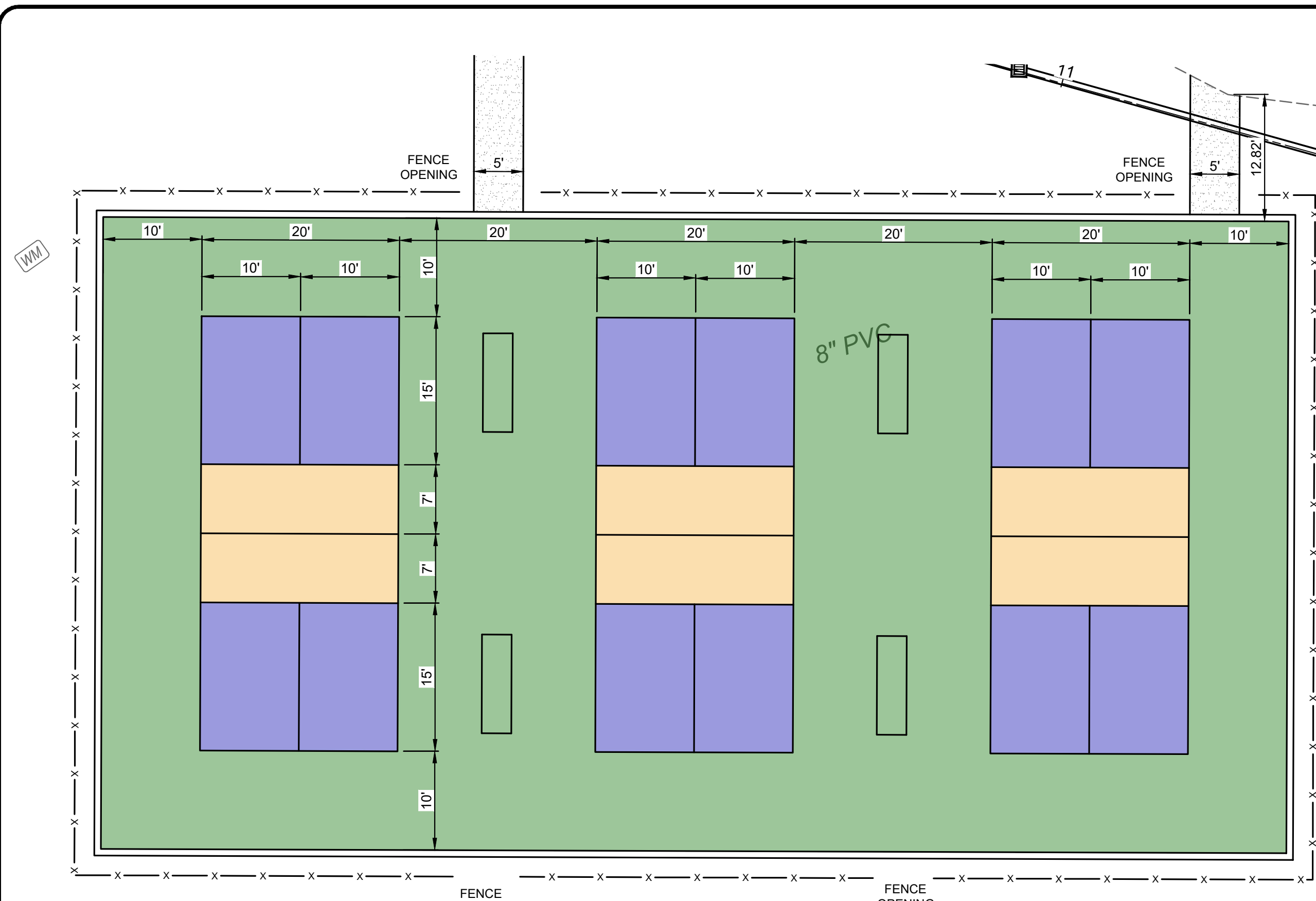

COURT COLORING HATCH LEGEND

- COLOR: PMS 357 c GREEN
- COLOR: PMS 138c ORANGE
- COLOR: PMS 662 c BLUE

NOTE: ALL STRIPING TO BE 2" WIDE WHITE. ALL DIMENSIONS GIVEN TO THE OUTSIDE EDGE OF THE STRIPE

NOTE: COLORS PROVIDED ARE INTENDED TO CLOSELY MATCH COLORS IDENTIFIED IN THE CITY OF EDGEWOOD'S LOGO/BRANDING GUIDELINES. COLORS INDICATED SHOULD MATCH PANTONE SWATCHES. CONTRACTOR SHALL PROVIDE COLOR SAMPLE FOR REVIEW BY THE CITY PRIOR TO PLACEMENT OF THE COLORING

COURT DIMENSIONS - BASE OPTION
NOTE: DIMENSIONS TO THE OUTSIDE OF WHITE STRIPE.

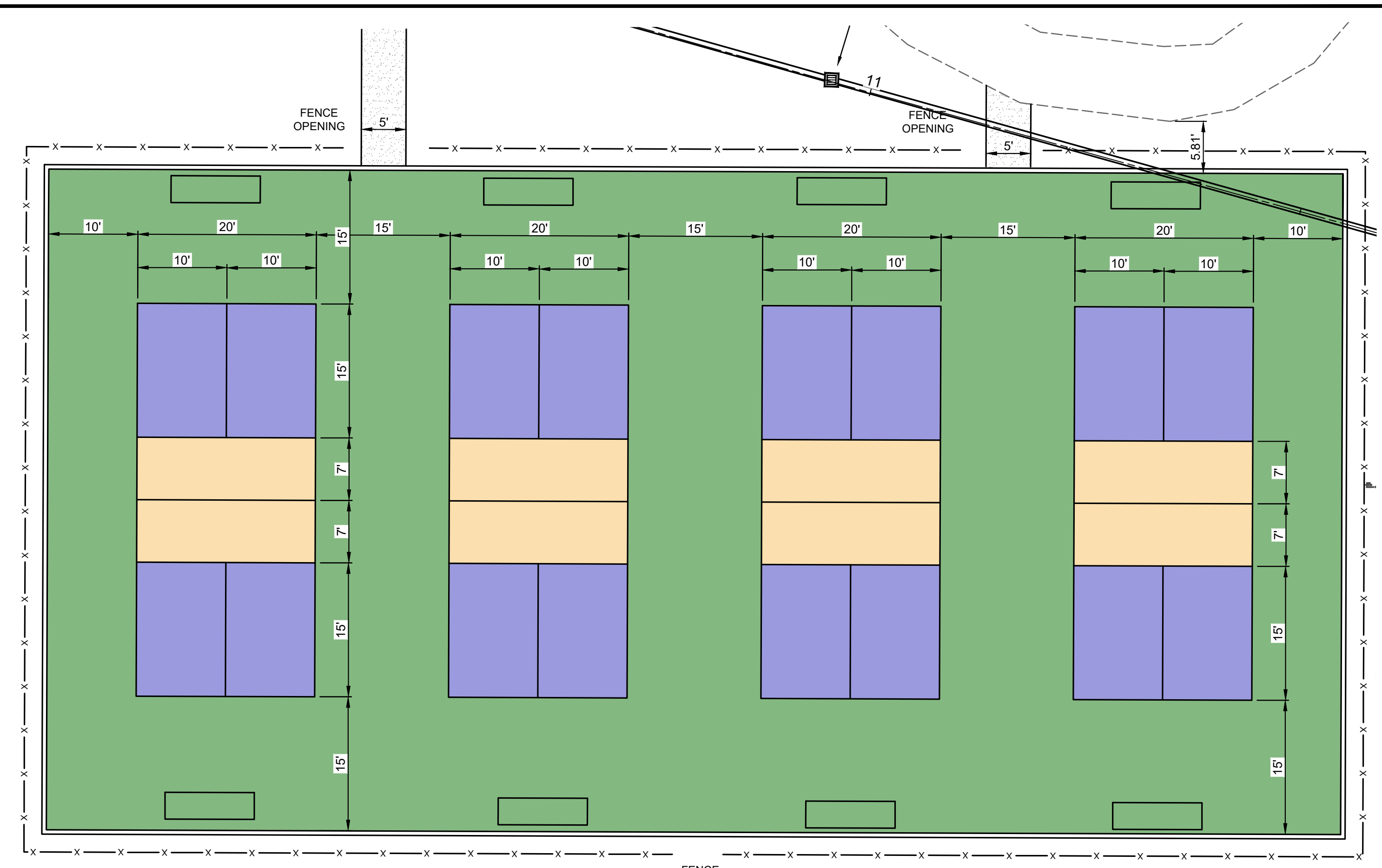

COURT COLORING HATCH LEGEND

- COLOR: PMS 357 c GREEN
- COLOR: PMS 138c ORANGE
- COLOR: PMS 662 c BLUE

NOTE: ALL STRIPING TO BE 2" WIDE WHITE. ALL DIMENSIONS GIVEN TO THE OUTSIDE EDGE OF THE STRIPE

NOTE: COLORS PROVIDED ARE INTENDED TO CLOSELY MATCH COLORS IDENTIFIED IN THE CITY OF EDGEWOOD'S LOGO/BRANDING GUIDELINES. COLORS INDICATED SHOULD MATCH PANTONE SWATCHES. CONTRACTOR SHALL PROVIDE COLOR SAMPLE FOR REVIEW BY THE CITY PRIOR TO PLACEMENT OF THE COLORING

COURT DIMENSIONS - ALTERNATE OPTION
NOTE: DIMENSIONS TO THE OUTSIDE OF WHITE STRIPE.

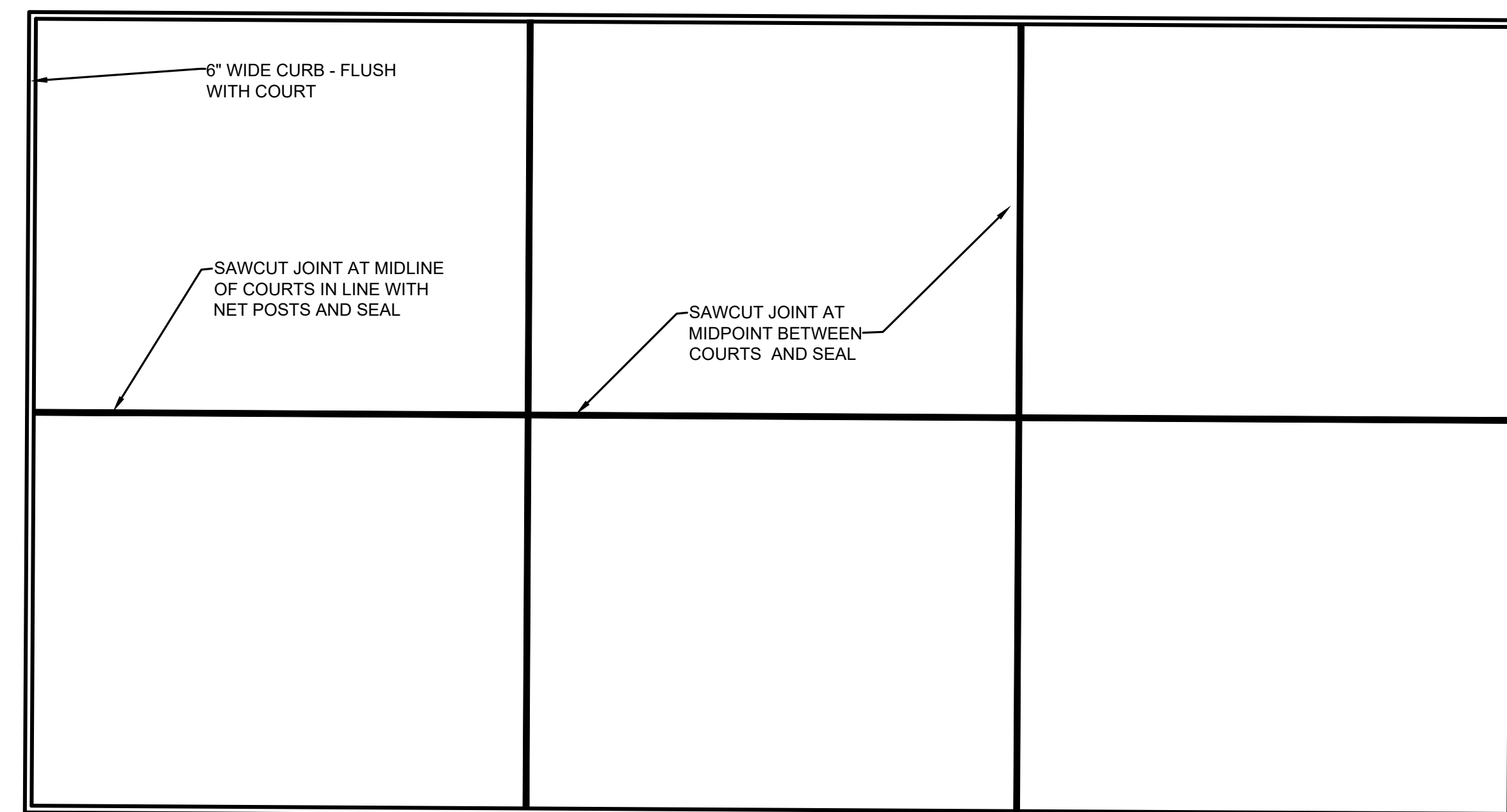

PAVEMENT JOINT DETAIL - BASE OPTION

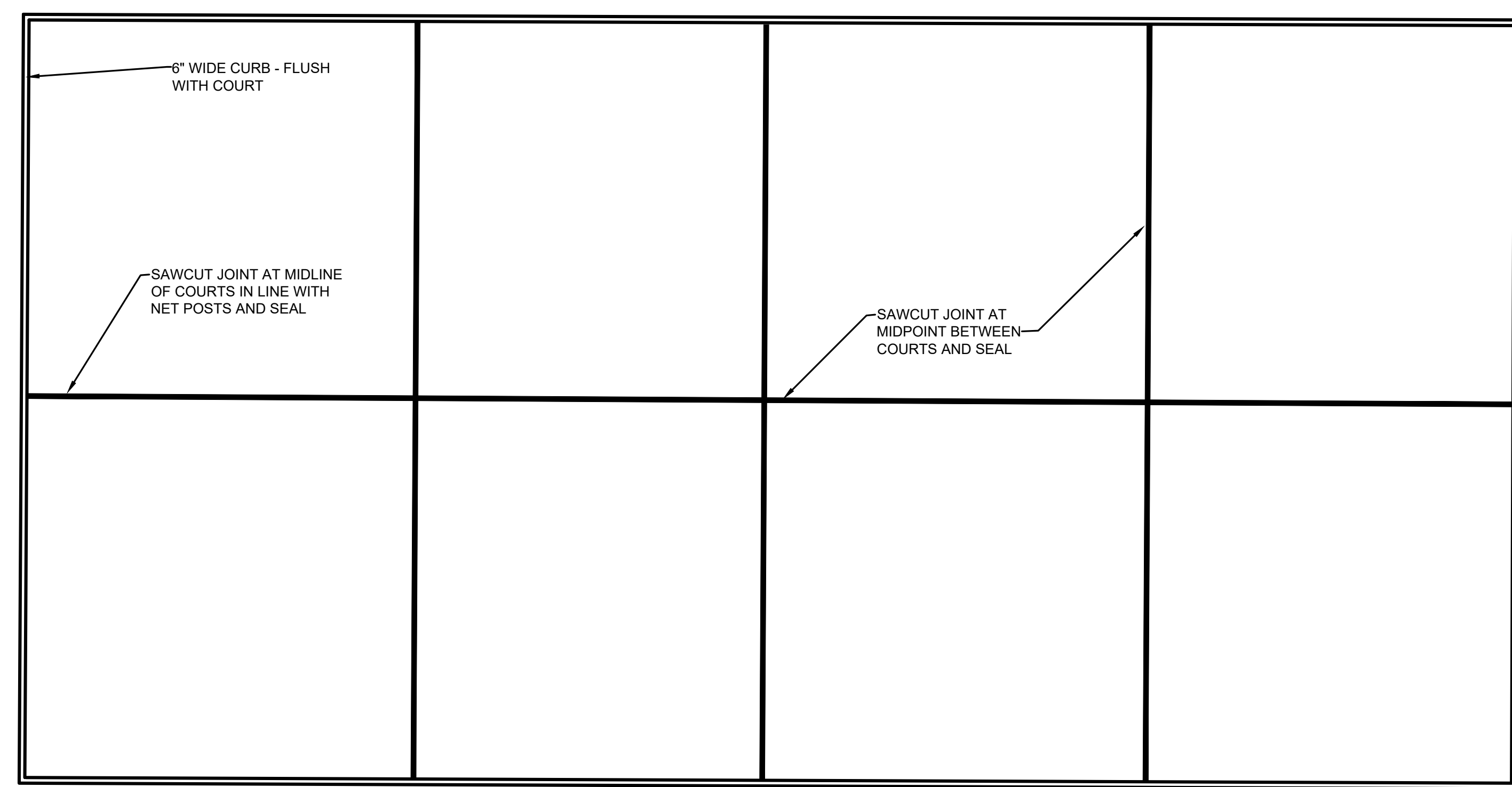

PAVEMENT JOINT DETAIL - ALTERNATE OPTION

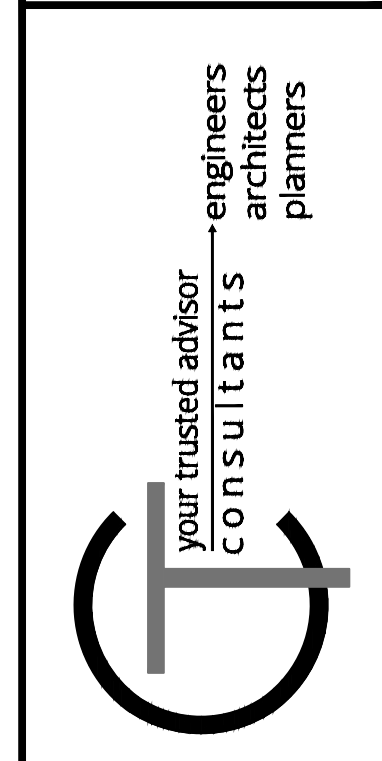

| REVISION | NO | DATE |
|----------------------|--------|------|
| ISSUED FOR: | REVIEW | DATE |
| ISSUE DATE: 07/13/23 | NO | |
| SCALE: AS SHOWN | NO | |
| DESIGNED BY: DGAR | NO | |
| DRAWN BY: DGAR | NO | |
| CHECKED BY: MHEL | NO | |

FREEDOM PARK PICKLEBALL COURTS
CITY OF EDGEWOOD
- KENTON COUNTY, KENTUCKY -
DETAIL SHEET 1

| | |
|-------------|--------|
| PROJECT NO: | 231224 |
| DISCIPLINE: | CIVIL |
| SHEET NAME: | C8 |
| SHEET: | 8 |
| OF: | 10 |

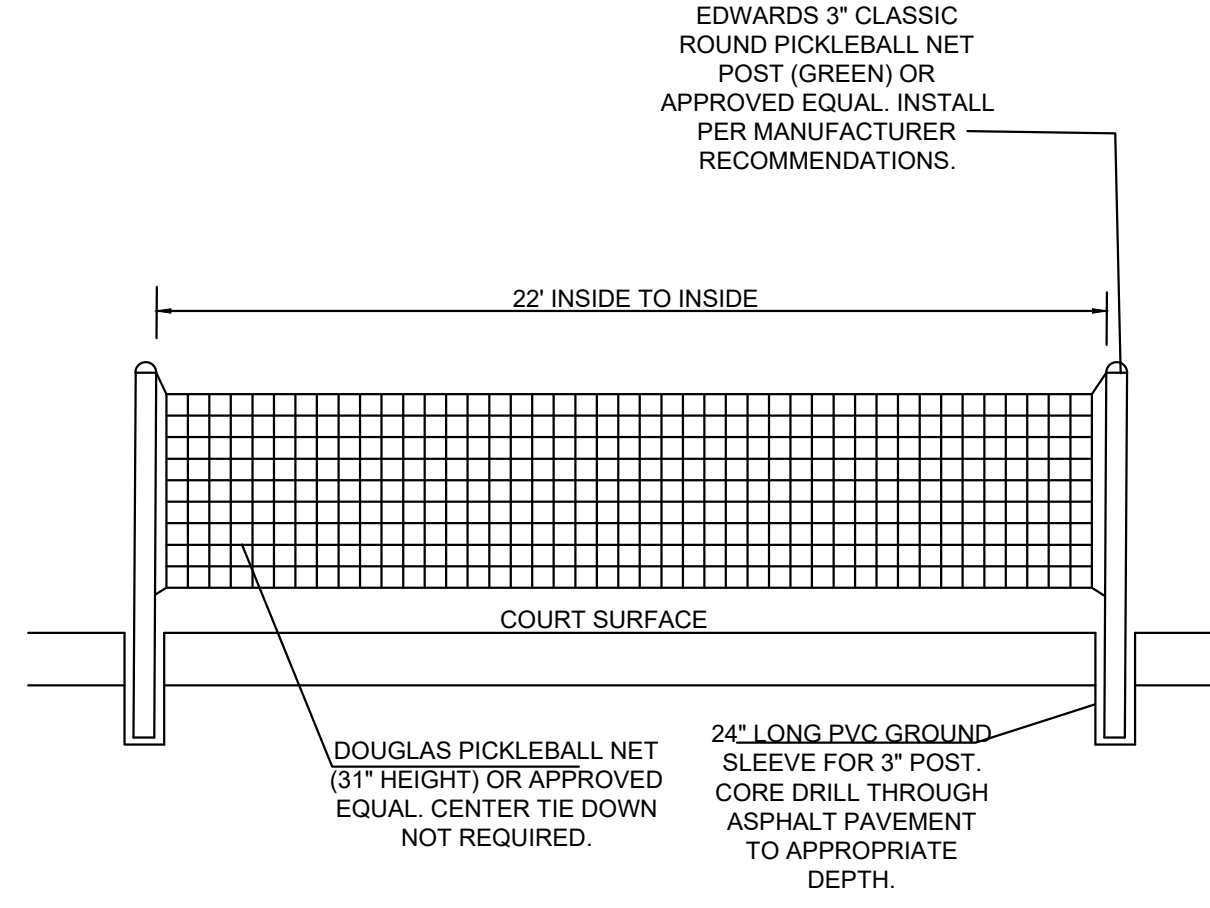

PICKLEBALL NET AND POST DETAIL

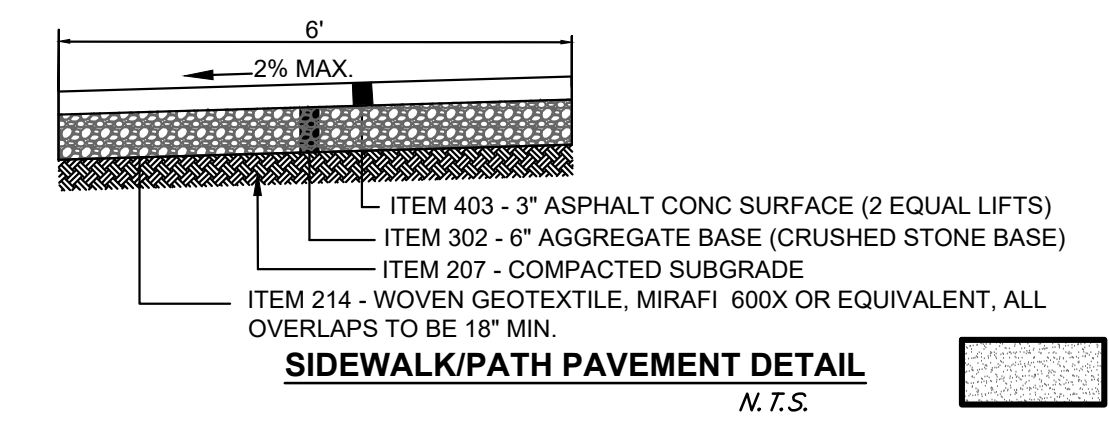

SIDEWALK/PATH PAVEMENT DETAIL
N.T.S.

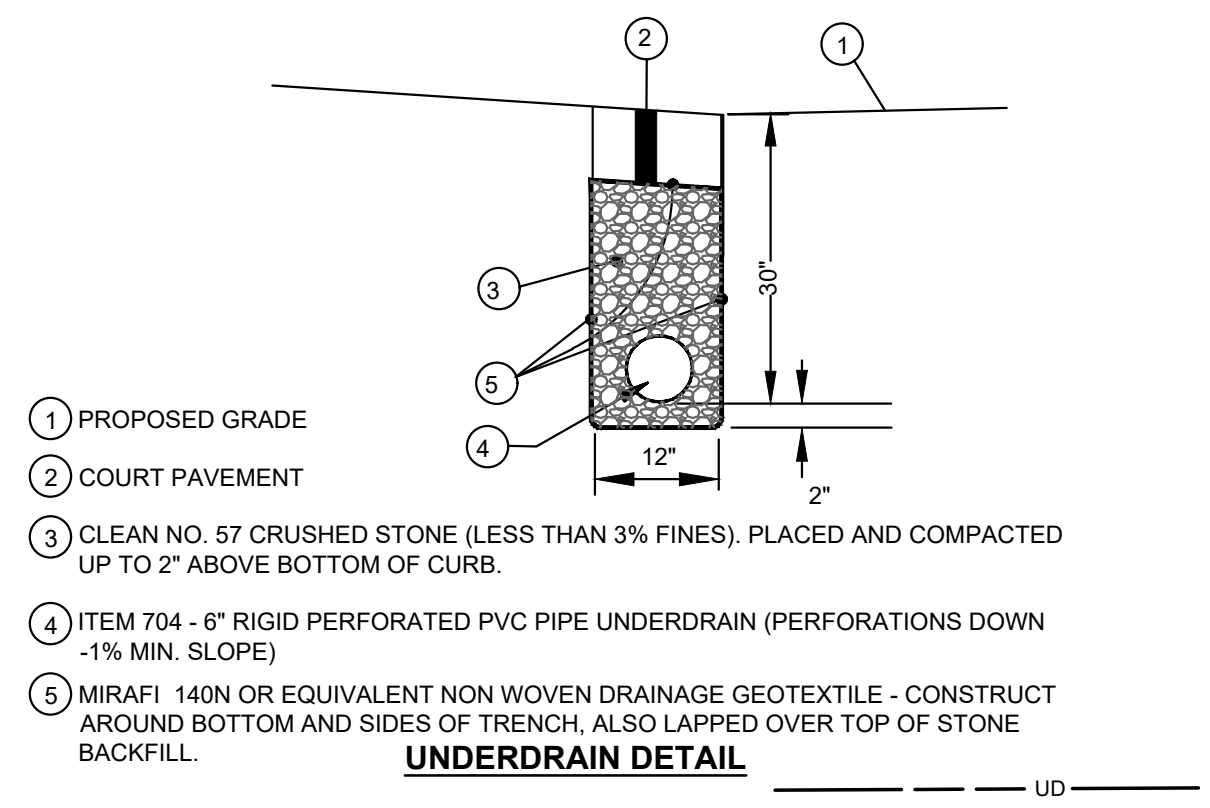

UNDERDRAIN DETAIL

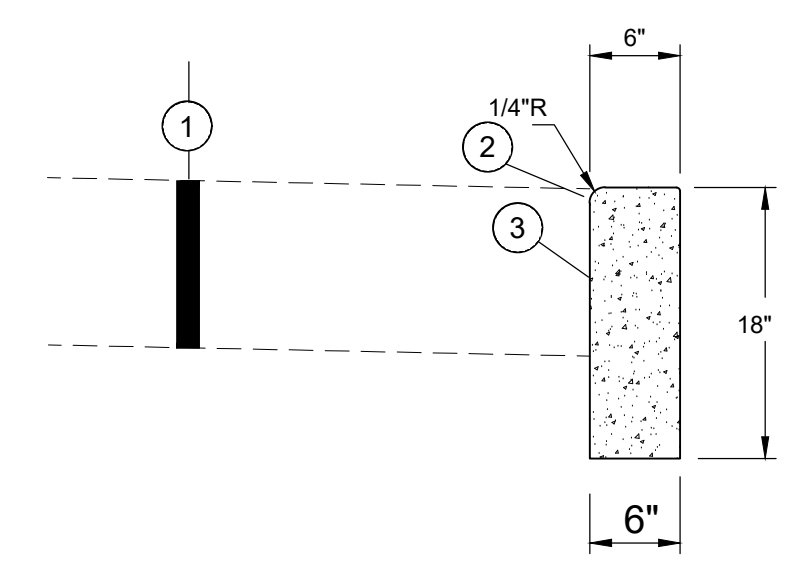

PERIMETER CURB DETAIL

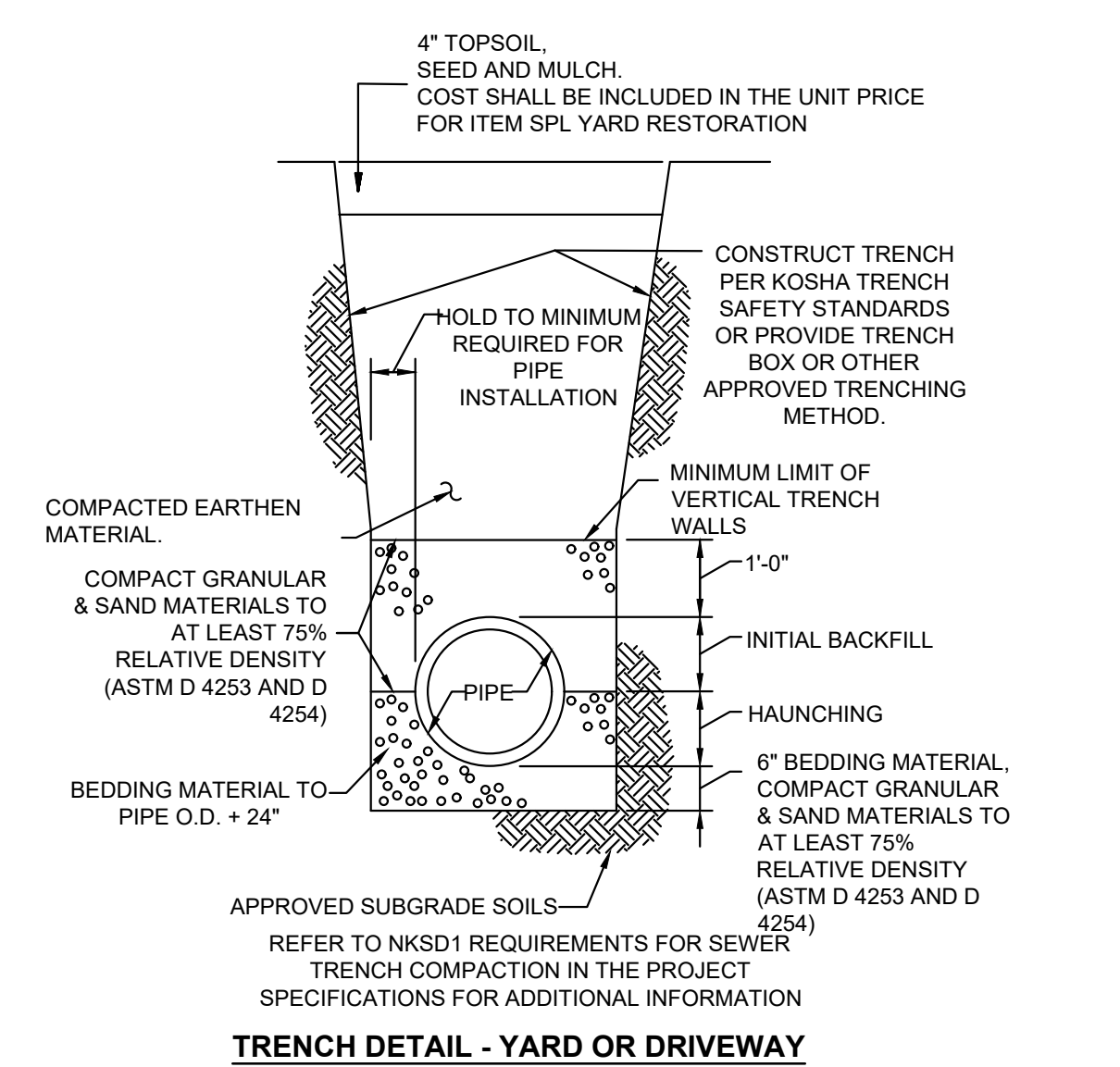

TRENCH DETAIL - YARD OR DRIVEWAY

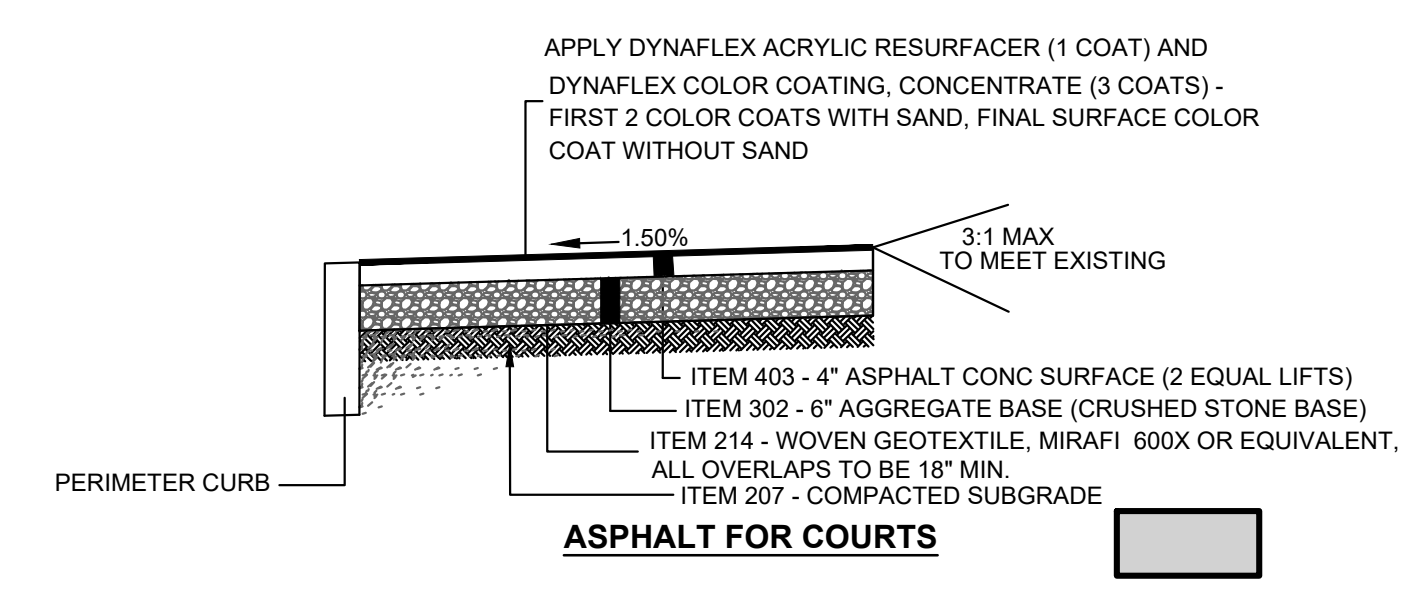

ASPHALT FOR COURTS

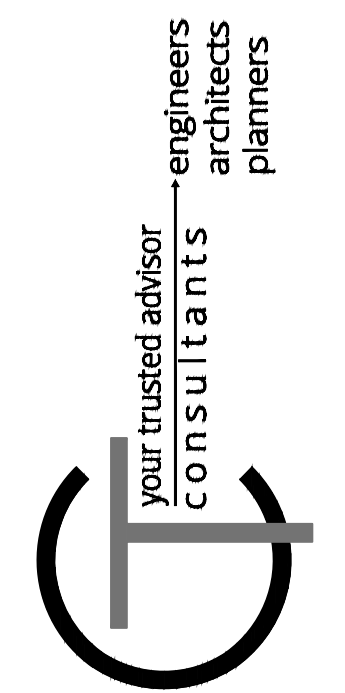

| DATE | REVISION | NO | REVIEW | ISSUED FOR: |
|------|----------|----|-------------------|-------------|
| | | | 07/13/23 | |
| | | | AS SHOWN | |
| | | | DESIGNED BY: DGAR | |
| | | | DRAWN BY: DGAR | |
| | | | CHECKED BY: MHEL | |

FREEDOM PARK PICKLEBALL COURTS
CITY OF EDGEWOOD
- KENTON COUNTY, KENTUCKY -

DETAIL SHEET 2

| | |
|-------------|--------|
| PROJECT NO. | 231224 |
| DISCIPLINE | CIVIL |
| SHEET NAME | C9 |
| SHEET | 9 |
| OF | 10 |

STORM WATER POLLUTION PREVENTION NOTES

- SANITATION DISTRICT NO. 1 IS TO BE CONTACTED 72 HOURS PRIOR TO ANY CONSTRUCTION ACTIVITY AT 859-578-6882
- ALL EROSION AND SEDIMENTATION CONTROL SHALL BE PERFORMED AS SHOWN ON THE PLANS, AND SHALL BE IN COMPLIANCE WITH THE LATEST CONSTRUCTION ACTIVITY "NATIONAL POLLUTANT DISCHARGE ELIMINATION SYSTEM" RULES AND REGULATIONS.
- A COPY OF THE STORM WATER POLLUTION PREVENTION PLAN (SWPPP) AND A COPY OF THE "NOTICE OF INTENT" (NOI) SHALL BE KEPT ON SITE.
- AN AMENDMENT OF THE SWPPP IS REQUIRED WHENEVER A CHANGE IN DESIGN, CONSTRUCTION, AND OPERATION OR MAINTENANCE HAS A SIGNIFICANT EFFECT ON THE POTENTIAL FOR THE DISCHARGE OF POLLUTANTS, OR IF THE SWPPP PROVES TO BE INEFFECTIVE IN ACHIEVING THE GENERAL OBJECTIVES OF THE SWPPP.
- THE CONTRACTOR SHALL ALSO MAINTAIN THE FOLLOWING RECORDS ON SITE:
 - GENERAL CONTRACTOR AND/OR SUBCONTRACTOR SWPPP CERTIFICATIONS
 - THE DATE, TIME, AND EXACT LOCATION OF THE INSPECTION, AND THE NAME OF THE INSPECTOR
 - AN ASSESSMENT OF THE CONDITION OF THE EROSION CONTROLS
 - A DESCRIPTION OF ANY EROSION CONTROL IMPLEMENTATION AND MAINTENANCE PERFORMED
 - A DESCRIPTION OF THE PRESENT PHASE OF CONSTRUCTION AT THE SITE
- CONSTRUCTION SEQUENCE
 - ALL PERIMETER SILT FENCE, INLET PROTECTION AND OTHER EROSION CONTROLS SHALL BE IN PLACE BEFORE ANY OTHER EARTH MOVING ACTIVITIES BEGIN.
 - THE CONTRACTOR SHALL CLEAR AND GRUB ONLY THE AREAS PLANNED FOR EARTH MOVING.
 - REMOVE TOPSOIL, STOCKPILE IT, AND INSTALL SILT FENCE AROUND PERIMETER.
 - SEED SOIL STOCKPILE WITH PERENNIAL RYE GRASS AND MULCH WITH STRAW IF NO TO BE DISTURBED FOR MORE THAN 21 DAYS.
 - CONSTRUCT DETENTION BASIN AND CONTROL STRUCTURE.
 - DETENTION BASIN SHALL BE USED AS A SEDIMENT BASIN UNTIL THE SITE IS STABILIZED.
 - INSTALL STORM SEWER SYSTEM AND SURFACE STORM INLET AND MANHOLE PROTECTION.
 - ESTABLISH A TEMPORARY SEEDING ON ALL BARE AREAS THAT ARE TO REMAIN UNDISTURBED FOR MORE THAN 21 DAYS. SEED WITH PERENNIAL RYE GRASS MULCH WITH STRAW.
 - IMMEDIATE AFTER TOPSOIL HAS BEEN PLACED, STABILIZE THE SAME SURFACE AREA WITH FINAL SEED AND MULCH 7 DAYS AFTER REACHING FINAL GRADE.
 - AFTER THE VEGETATION HAS BECOME WELL ESTABLISHED, REMOVE TEMPORARY EROSION OR SEDIMENT CONTROL PRACTICES.
- EROSION CONTROLS MUST BE INSPECTED EVERY 7 DAYS AND WITHIN 24 HOURS OF 0.5" OR GREATER RAINFALL. REMOVE ACCUMULATED SEDIMENT FROM EROSION CONTROLS.
- TEMPORARY SEEDING SHALL BE PERENNIAL RYE GRASS (40 LB / ACRE) AND MULCH AT 3 BALES OF STRAW PER 1000 S.F.
- CONTRACTOR IS RESPONSIBLE FOR OBTAINING BORROW MATERIAL ON-SITE AND / OR DISPOSING OF EXCESS MATERIAL OFF SITE AS REQUIRED TO MEET INDICATED DESIGN ELEVATIONS.
- DEBRIS SHALL BE COLLECTED WITHIN PROPERTY LIMITS WEEKLY OR AS NEEDED FOR PUBLIC SAFETY. SURROUNDING STREETS AFFECTED BY THE CONSTRUCTION SHALL BE CLEANED DAILY OR AS NEEDED FOR PUBLIC SAFETY. SEE CONSTRUCTION ENTRANCE DETAIL IN SWPPP DETAILS SHEET.
- THE CONSTRUCTION OF BMPs SHALL BE REVISED OR ADDED IF DEEMED NECESSARY PER SECTION 1000 OF THE SANITATION DISTRICT 1 REGULATIONS.
- CONTACT SANITATION DISTRICT NO. 1 72 HOURS PRIOR TO INSTALLATION OF THE WATER QUALITY FEATURE.

SEDIMENT BASINS

DEFINITION
A TEMPORARY BARRIER OR DAM CONSTRUCTED ACROSS A WATERCOURSE OR AT OTHER SUITABLE LOCATION TO RETAIN SEDIMENT AND OTHER WATERBORNE DEBRIS.

SCOPE
THIS STANDARD ESTABLISHES MINIMUM ACCEPTABLE QUALITY FOR THE DESIGN AND CONSTRUCTION OF TEMPORARY SEDIMENT BASINS FORMED BY AN EMBANKMENT, EXCAVATION OR A COMBINATION OF EMBANKMENT AND EXCAVATION. THE STANDARD IS LIMITED TO SITES WHERE:

- FAILURE OF THE STRUCTURE WOULD NOT RESULT IN LOSS OF LIFE; DAMAGE TO HOMES, COMMERCIAL OR INDUSTRIAL BUILDINGS; DAMAGE TO HIGHWAYS OR ROADWAYS OR INTERRUPTION OF USE OR SERVICE OF PRIVATE UTILITIES.
- THE HEIGHT OF DAM IS 25 FEET OR LESS, AS MEASURED FROM THE NATURAL STREAMBED AT THE CENTERLINE OF DAM TO THE TOP OF DAM.
- THE TOTAL VOLUME OF STORAGE IS 150 ACRE-FEET OR LESS.
- THE DRAINAGE AREA IS 100 ACRES OR LESS.
- THE BASIN WILL BE REMOVED WITHIN A THREE-YEAR PERIOD AFTER CONSTRUCTION.

PURPOSE
TEMPORARY SEDIMENT BASINS ARE USED AS A MEANS OF TRAPPING AND STORING SEDIMENT FROM ERODING AREAS IN ORDER TO PROTECT DOWNSTREAM AREAS FROM DAMAGE RESULTING FROM SEDIMENTATION AND WATERBORNE DEBRIS.

CONDITIONS WHERE PRACTICE APPLIES
TEMPORARY SEDIMENT BASINS APPLY WHERE PHYSICAL SITE CONDITIONS OR OTHER RESTRICTIONS PRECLUDE THE INSTALLATION OF EROSION CONTROL MEASURES TO ADEQUATELY CONTROL EROSION AND SEDIMENTATION. IT MAY BE USED DOWNSLOPE FROM CONSTRUCTION OPERATIONS WHICH EXPOSE AREAS TO EROSION. TEMPORARY SEDIMENT BASINS WILL BE REMOVED AFTER THE EXPOSED AREAS ARE ADEQUATELY PROTECTED AGAINST EROSION BY VEGETATIVE OR MECHANICAL MEANS.

COMPLIANCE WITH LAWS AND REGULATIONS
DESIGN AND CONSTRUCTION SHALL COMPLY WITH ALL LOCAL LAWS, ORDINANCES, RULES AND REGULATIONS.

LOCATION
TO IMPROVE THE EFFECTIVENESS OF THE BASIN, IT SHOULD BE LOCATED SO AS TO INTERCEPT THE LARGEST POSSIBLE AMOUNT OF RUNOFF FROM THE DISTURBED AREA. THE BEST LOCATIONS ARE GENERALLY LOW AREAS AND NATURAL DRAINAGEWAYS BELOW DISTURBED AREAS. DRAINAGE INTO THE BASIN CAN BE IMPROVED BY THE USE OF DIVERSION DIKES AND DITCHES. THE BASIN MUST NOT BE LOCATED IN A LIVE STREAM BUT SHOULD BE LOCATED TO TRAP SEDIMENT-LADEN RUNOFF BEFORE IT ENTERS THE STREAM. THE BASIN SHOULD NOT BE LOCATED WHERE ITS FAILURE WOULD RESULT IN THE LOSS OF LIFE OR IN INTERRUPTION OF THE USE OR SERVICE OF PUBLIC UTILITIES OR ROADS.

MULTIPLE USE
SEDIMENT BASINS MAY BE DESIGNED AS PERMANENT STRUCTURES TO REMAIN IN PLACE AFTER CONSTRUCTION IS COMPLETED. SITE CONDITIONS MAY MAKE THE USE OF THESE STRUCTURES DESIRABLE FOR STORMWATER DETENTION PURPOSES. WHEN THESE STRUCTURES ARE TO BECOME PERMANENT, OR IF THEY EXCEED THE SIZE LIMITATIONS OF THE DESIGN CRITERIA, THEY MUST BE DESIGNED AS PERMANENT PONDS BY A QUALIFIED PROFESSIONAL ENGINEER. PERMANENT PONDS ARE BEYOND THE SCOPE OF THESE STANDARDS AND SPECIFICATIONS. THE PERMANENT STRUCTURES MUST BE SUBMITTED WITH CONSTRUCTION DRAWINGS FOR REVIEW AND ACCEPTANCE BY THE CITY ENGINEER.

MAINTENANCE BASINS SHALL BE CHECKED WEEKLY AND CLEANED WHEN NO LONGER EFFECTIVE.

STORM DRAIN INLET PROTECTION
DEFINITION
A SEDIMENT FILTER INSTALLED AROUND A STORM DRAIN INLET OR CURB INLET TO REDUCE SEDIMENT DISCHARGE.

PURPOSE
TO PREVENT SEDIMENT FROM ENTERING THE STORM DISCHARGE SYSTEMS PRIOR TO PERMANENT STABILIZATION OF THE DISTURBED DRAINAGE AREA. DIFFERENT TYPES OF STRUCTURES ARE APPLICABLE TO DIFFERENT CONDITIONS.

NOTES:

- SUBSOILING SHALL OCCUR WHEN SOIL MOISTURE IS LOW ENOUGH TO ALLOW THE SOIL TO CRACK OR FRACTURE. SUBSOILING IS NOT PERMITTED ON SLIP-PRONE AREAS.
- THE SITE SHALL BE GRADED TO PERMIT THE USE OF CONVENTIONAL EQUIPMENT FOR SEEDBED PREPARATION AND SEEDING.
- TOPSOIL SHALL BE APPLIED WHERE NEEDED TO ESTABLISH VEGETATION.
- THE SEEDBED SHALL BE PREPARED BY APPLYING AGRICULTURAL GROUND LIMESTONE OR FERTILIZER AS RECOMMENDED BY A SOIL TEST. IN LIEU OF A SOIL TEST, APPLY LIME AT 2 TONS/AC. OR FERTILIZER AT 500 LB/AC. OF 10-10-10 OR 12-12-12 ANALYSIS. LIME AND FERTILIZER SHALL BE WORKED INTO THE SOIL TO A DEPTH OF 3".
- APPLY SEED UNIFORMLY ON FIRM, MOIST SEED BED.
- SEEDING SHOULD BE APPLIED FROM MARCH 1 TO MAY 31 OR AUGUST 1 TO SEPTEMBER 30. IF SEEDING OCCURS OUTSIDE OF THESE DATES, ADDITIONAL MULCH AND IRRIGATION MAY BE REQUIRED TO ENSURE A MINIMUM OF 80% GERMINATION. TILLAGE FOR SEEDBED PREPARATION SHALL OCCUR WHEN THE SOIL IS DRY ENOUGH TO CRUMBLE AND NOT FORM RIBBONS WHEN COMPRESSED BY HAND.
- SEEDING SHOULD NOT BE APPLIED FROM OCTOBER 1 TO NOVEMBER 20 BECAUSE SEEDS MAY GERMINATE, BUT WILL NOT SURVIVE THE WINTER. USE THE FOLLOWING METHODS FOR DORMANT SEEDING:
 - FROM OCTOBER 1 TO NOVEMBER 20, INCREASE THE SEEDING RATE BY 50%, PREPARE THE SEED BED, ADD LIME AND FERTILIZER, MULCH AND ANCHOR.
 - FROM NOVEMBER 20 TO MARCH 15, ONLY IF SOIL CONDITIONS PERMIT, INCREASE THE SEEDING RATE BY 50%, PREPARE THE SEED BED, ADD LIME AND FERTILIZER, APPLY THE SEED MIXTURE, MULCH AND ANCHOR.
- APPLY MULCH MATERIAL IMMEDIATELY AFTER SEEDING.
- PERMANENT SEEDING SHALL INCLUDE IRRIGATION TO ESTABLISH VEGETATION DURING DRY OR HOT WEATHER OR ON ADVERSE SITE CONDITIONS AS NEEDED. AVOID EXCESSIVE IRRIGATION AND MONITOR TO PREVENT EROSION AND DAMAGE FROM RUNOFF.
- PERMANENT SEEDING SHALL NOT BE CONSIDERED ESTABLISHED FOR AT LEAST 1 FULL YEAR FROM THE TIME OF PLANTING. DURING THIS PERIOD, INSPECT FOR SOIL EROSION OR PLANT LOSS AND REPAIR BARE OR SPARSE AREAS, FILL GULLIES, RE-FERTILIZE, RE-SEED OR RE-MULCH AS NEEDED.
- A MINIMUM OF 70% GROWTH DENSITY, BASED ON A VISUAL INSPECTION, MUST EXIST FOR AN ADEQUATE PERMANENT VEGETATIVE PLANTING.

| MIXTURE | FORMULA | LB/ AC. | TIME | MOW |
|--|----------|---------|--------------------------------------|------------|
| CREeping RED FESCUE DOMESTIC RYEGRASS KENTUCKY BLUEGRASS | 10-10-10 | 500 | FALL, YEARLY, OR AS NEEDED | ≥3" |
| TALL FESCUE | 10-10-10 | 500 | | ≥4" |
| TURF-TYPE FESCUE | 10-10-10 | 500 | | |
| CROWN VETCH FESCUE | 0-20-20 | 400 | SPRING, AND YEARLY AFTER ESTABLISHED | DO NOT MOW |
| FLAT PEA FESCUE | 0-20-20 | 400 | | |

| SEED MIX | SEED RATE LB/AC. | NOTES: |
|--|-------------------------------|--|
| GENERAL USE | | |
| CREeping RED FESCUE DOMESTIC RYEGRASS KENTUCKY BLUEGRASS | 20 - 40 10 - 20 20 - 40 | FOR CLOSE MOWING AND WATERWAYS WITH ≤2.0 FT. SEC. VELOCITY |
| TALL FESCUE | 40 - 50 | |
| TURF-TYPE FESCUE | 90 | |
| STEep BANKS OR CUT SLOPES | | |
| TALL FESCUE | 40 - 50 | |
| CROWN VETCH TALL FESCUE | 10 - 20 20 - 30 | DO NOT SEED LATER THAN AUGUST |
| FLAT PEA TALL FESCUE | 20 - 25 20 - 30 | DO NOT SEED LATER THAN AUGUST |
| ROAD DITCHES AND SWALES | | |
| TALL FESCUE | 40 - 50 | |
| TURF-TYPE FESCUE KENTUCKY BLUEGRASS | 90 5 | |
| LAWN | | |
| KENTUCKY BLUEGRASS PERENNIAL RYEGRASS | 100 - 120 100 - 120 | |
| KENTUCKY BLUEGRASS CREeping RED FESCUE | 100 - 120 100 - 120 | FOR SHADED AREAS |

| DATES | SPECIES | LB/1,000 SF | LB/AC. |
|-------------------------|--------------------|-------------|--------|
| MARCH 1 TO AUGUST 15 | OATS | 3 | 128 |
| | TALL FESCUE | 1 | 40 |
| | PERENNIAL RYEGRASS | 1 | 40 |
| AUGUST 16 TO NOVEMBER 1 | RYE | 3 | 112 |
| | TALL FESCUE | 1 | 40 |
| | PERENNIAL RYEGRASS | 1 | 40 |
| NOVEMBER 1 TO SPRING | WHEAT | 3 | 120 |
| | TALL FESCUE | 1 | 40 |
| | PERENNIAL RYEGRASS | 1 | 40 |
| NOVEMBER 1 TO SPRING | PERENNIAL RYEGRASS | 2 | 40 |
| | TALL FESCUE | 1 | 40 |

PERMANENT SEEDING DETAIL
SCALE: NONE

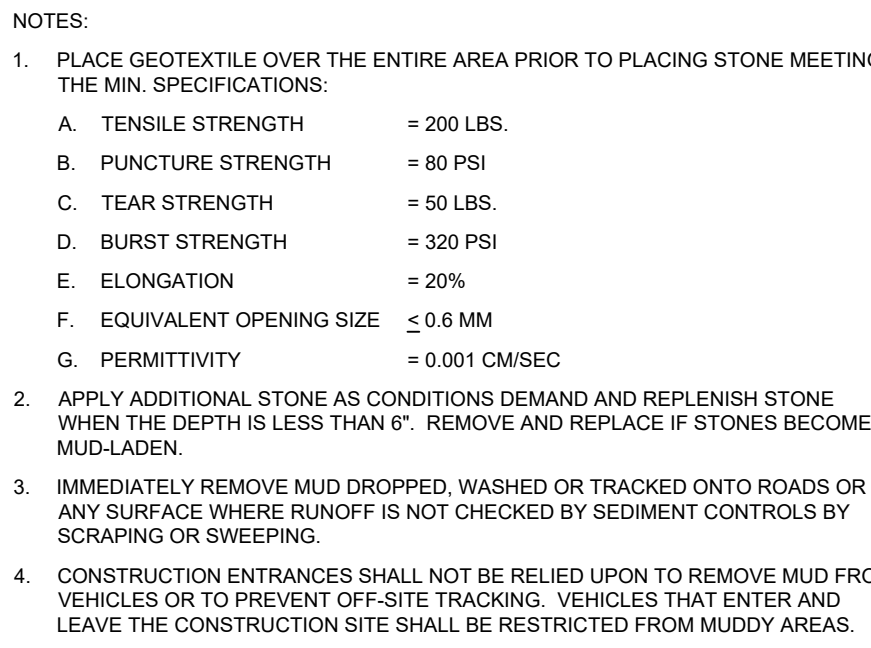
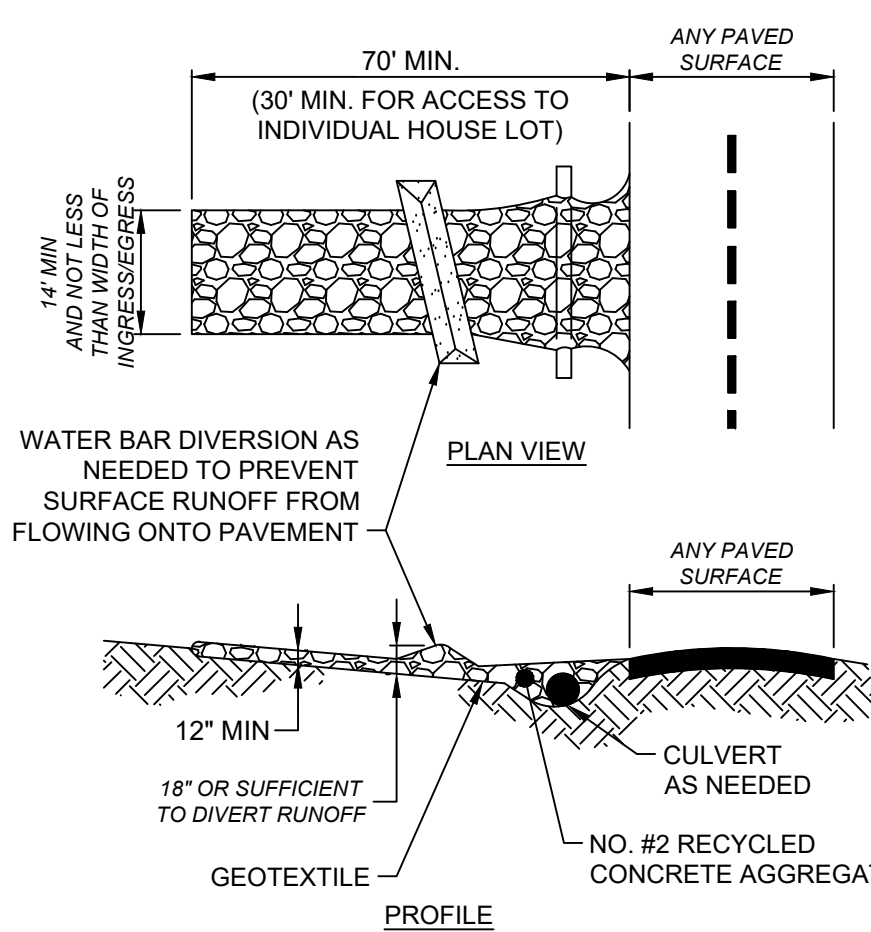

CONSTRUCTION ENTRANCE
SCALE: NONE

- NOTES:**
- THE SEED BED SHALL BE PULVERIZED AND LOOSE TO ENSURE THE SUCCESS OF ESTABLISHING VEGETATION.
 - SOIL AMENDMENTS MAY BE REQUIRED TO ESTABLISH ADEQUATE VEGETATION. PERFORM SOIL TESTS ON THE SITE TO PREDICT THE NEED FOR LIME AND FERTILIZER.
 - APPLY SEED UNIFORMLY. COVER BROADCAST SEED BY RAKING OR DRAGGING AND THEN LIGHTLY TAMPING INTO PLACE.
 - APPLY MULCHING IMMEDIATELY AFTER SEEDING.
 - SEEDING SHALL BE INSPECTED FOR BARE SPOTS AND WASHOUTS, AND RESEED AS NECESSARY.

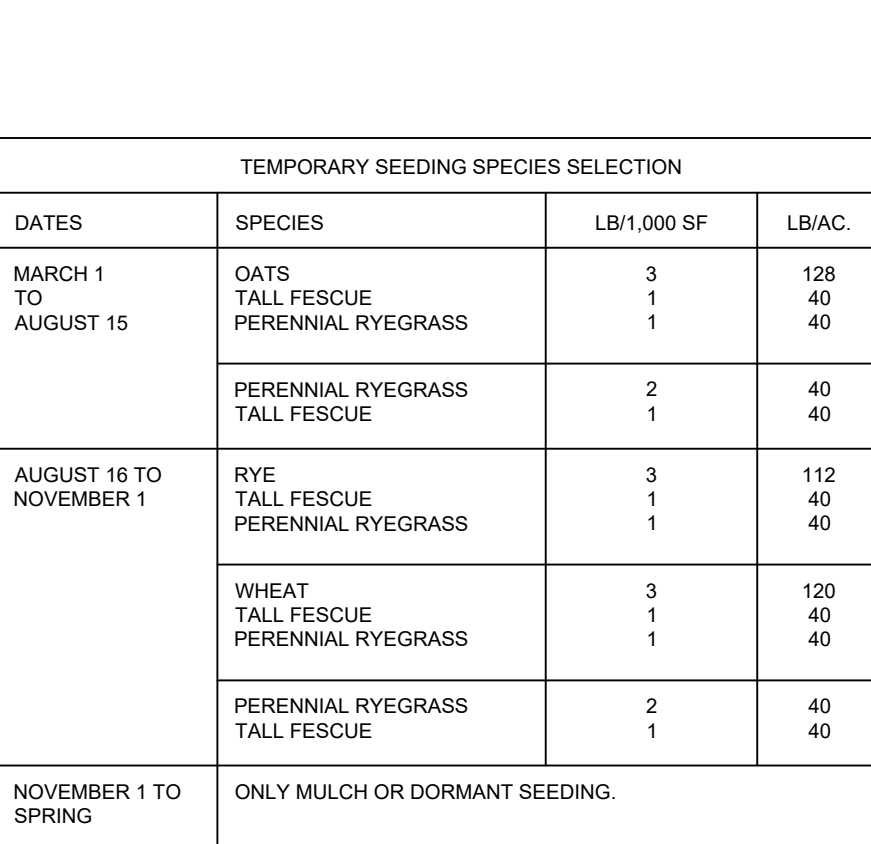

TEMPORARY SEEDING DETAIL
SCALE: NONE

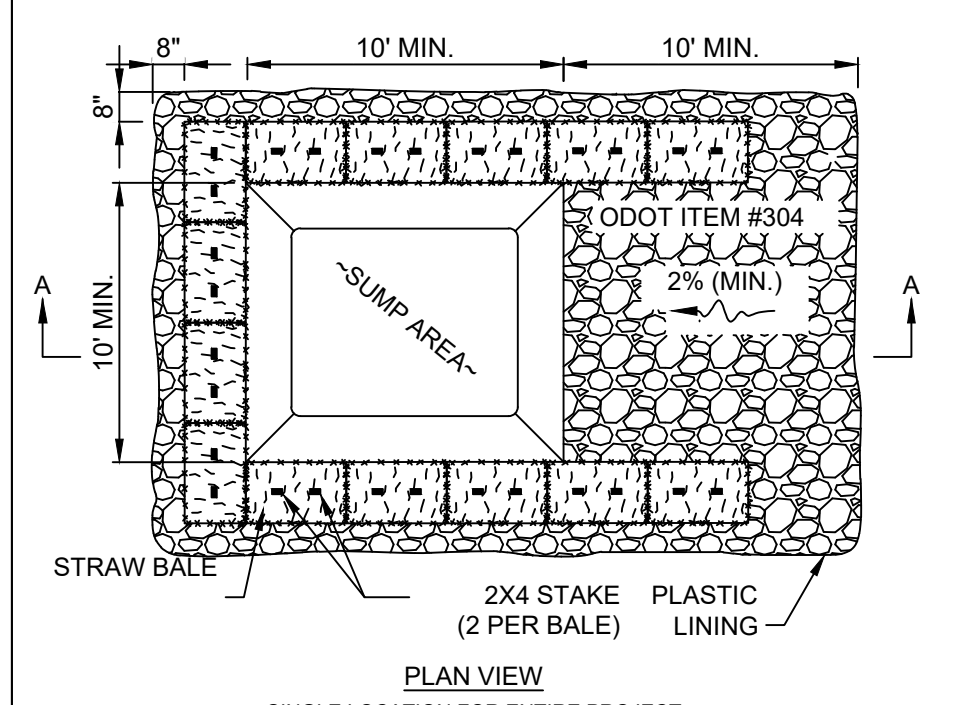
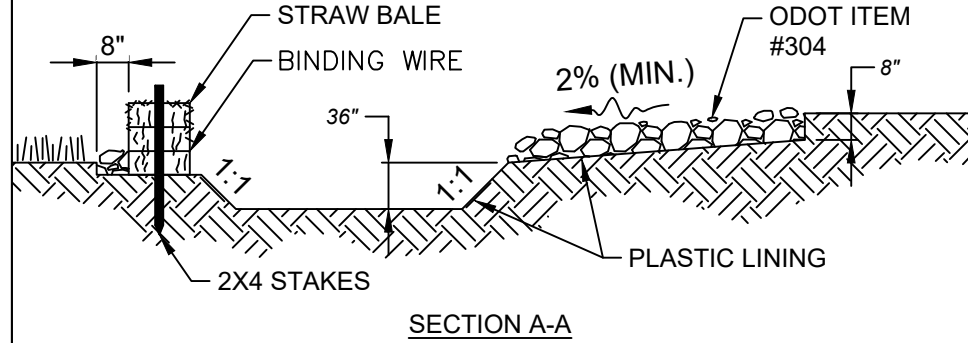

CONCRETE WASHOUT DETAIL

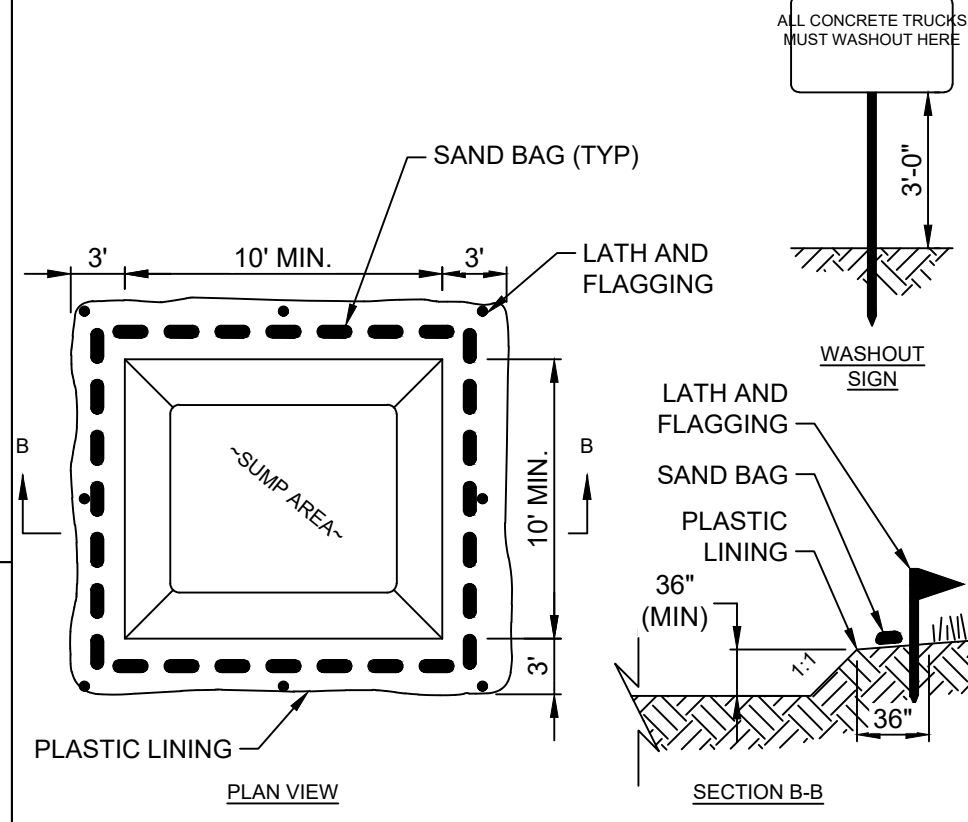

TEMPORARY LOCATION FOR MULTIPLE PHASE PROJECT

- NOTES:**
- WASHOUT PIT SHALL BE LOCATED 100' MINIMUM FROM INLETS, STREAMS, WETLANDS AND ANY OTHER SURFACE WATERS.
 - ALL EXCESS CONCRETE AND CONCRETE WASHOUT, INCLUDING FROM HAND MIXERS AND LIGHT EQUIPMENT, SHALL BE DISPOSED OF IN THE CONCRETE WASHOUT AREA. DISPOSAL OF EXCESS CONCRETE OR CONCRETE WASHOUT ON THE GROUND, OR IN STORM DRAINS, DITCHES OR WATER BODIES, IS PROHIBITED.
 - CONCRETE WASHOUT AREA SHALL BE SUFFICIENT SIZE TO CONTAIN CONCRETE WASTE GENERATED. FOR LARGER SITES, MULTIPLE CONCRETE WASHOUT AREAS MAY BE REQUIRED.
 - IF CONCRETE WASHOUT AREA IS LOCATED AWAY FROM A PAVED SURFACE, CONSTRUCT A GRAVEL ACCESS ROUTE EQUAL IN COMPOSITION TO THE CONSTRUCTION ENTRANCE.
 - PLASTIC LINING SHALL BE DOUBLE-LINED, CONTINUOUS 10-MIL POLYETHYLENE SHEETING FREE OF HOLES, TEARS OR OTHER DEFECTS, AND INSTALLED ON A SMOOTH LEVEL SURFACE, FREE OF ROCKS OR DEBRIS.
 - CONCRETE WASHOUT SIGNAGE SHALL BE CLEARLY VISIBLE AND LOCATED WITHIN 30 FEET OF EACH WASHOUT AREA.
 - CONCRETE WASHOUT AREAS SHALL BE COVERED DURING INCLEMENT WEATHER TO PREVENT OVERFLOWS.
 - PREFABRICATED, PORTABLE AND RE-USABLE CONCRETE WASHOUT CONTAINERS ARE ACCEPTABLE, BUT MUST BE SPECIFICALLY DESIGNED FOR CONCRETE WASHOUT USE.
 - CONCRETE WASHOUT AREA SHALL BE INSPECTED DAILY TO CHECK FOR DAMAGE AND TO DETERMINE IF IT NEEDS CLEANED OR REPLACED. ANY DAMAGE TO THE SIDEWALLS OR POLYETHYLENE SHEETING SHALL BE REPAIRED IMMEDIATELY. THE CONCRETE WASHOUT AREA SHALL BE CLEANED OR REPLACED WHEN IT IS 75% FULL. THE POLYETHYLENE SHEETING SHALL BE REPLACED AFTER EACH CLEANING.
 - SAW CUT CONCRETE, RESIDUE FROM SAW CUT, AND GRINDINGS SHALL BE DISPOSED OF IN THE WASHOUT PIT.

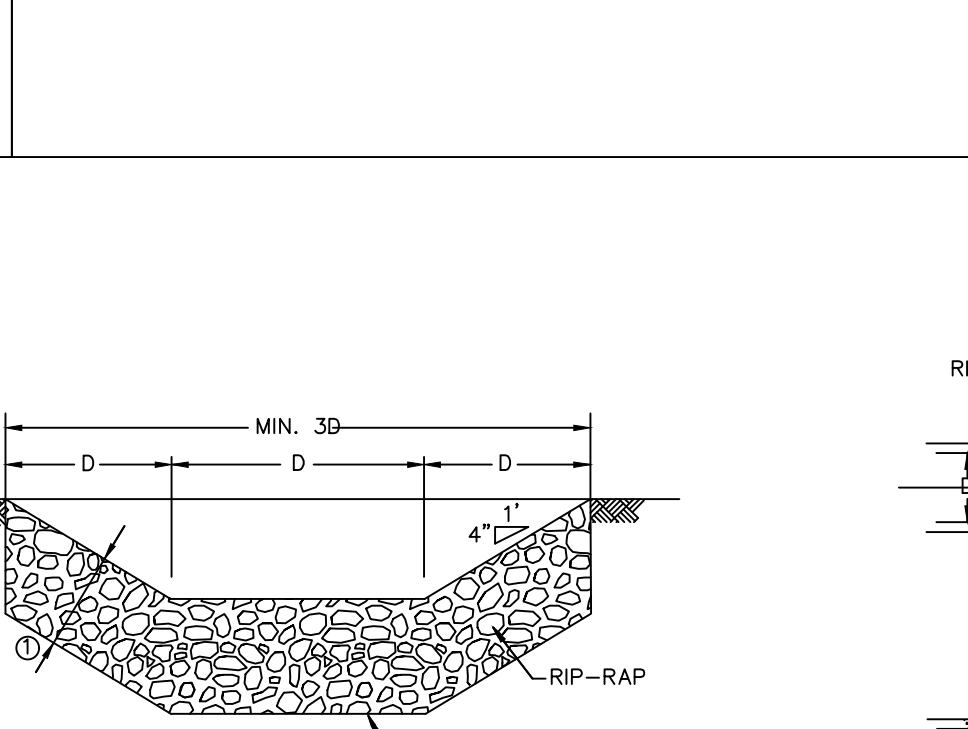

SECTION B-B
① 24" MIN. CLASS III CHANNEL LINING (RIP RAP)
D=INSIDE PIPE DIAMETER

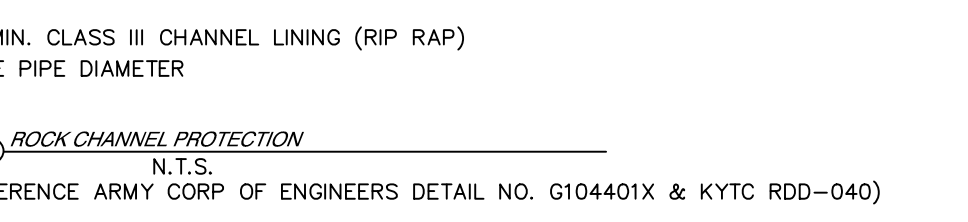

SECTION A-A
① 24" MIN. CLASS III CHANNEL LINING (RIP RAP)
D=INSIDE PIPE DIAMETER
N.T.S.
(REFERENCE ARMY CORP OF ENGINEERS DETAIL NO. G104401X & KYC RDD-040)

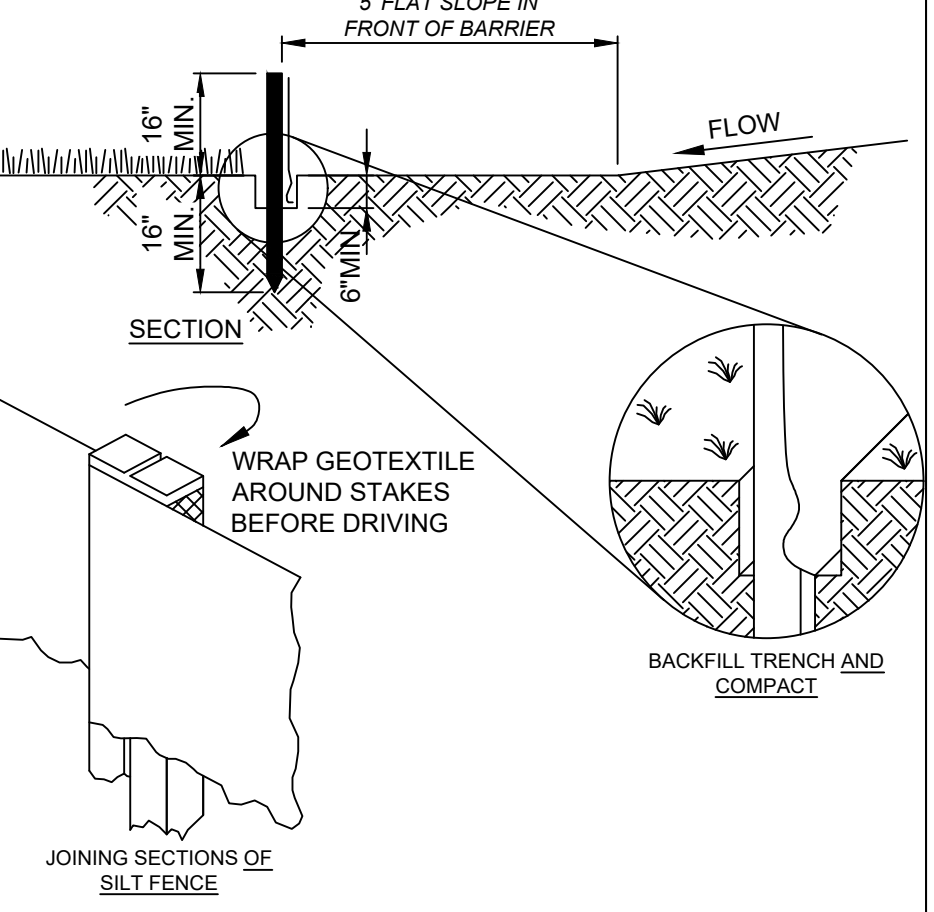
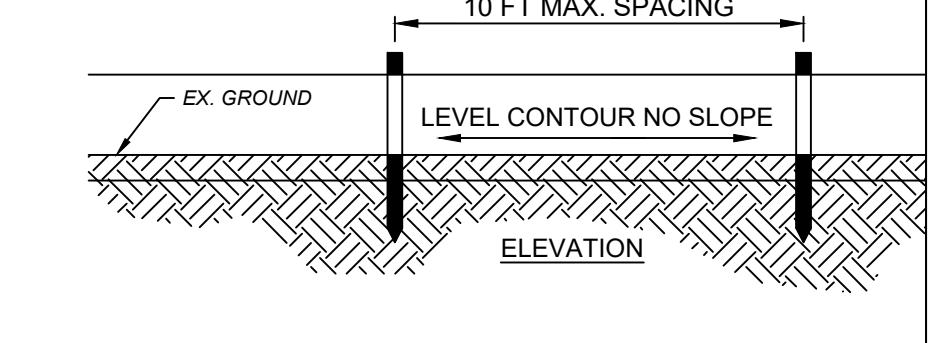

- NOTES:**
- PRESERVE VEGETATION FOR 5 FEET, OR AS MUCH AS POSSIBLE, UPSLOPE FROM THE SILT FENCE. IF VEGETATION IS REMOVED, IT SHALL BE RE-ESTABLISHED WITHIN 7 DAYS FROM SILT FENCE INSTALLATION.
 - SILT FENCE SHALL ALLOW RUNOFF TO PASS ONLY AS DIFFUSE FLOW THROUGH THE GEOTEXTILE. PERFORM ONE OF THE FOLLOWING IF RUNOFF OVERTOPS THE SILT FENCE: FLOWS UNDER OR AROUND THE ENDS, OR IN ANY OTHER WAY BECOMES A CONCENTRATED FLOW.
 - CHANGE THE LAYOUT OF THE SILT FENCE.
 - REMOVE ACCUMULATED SEDIMENT.
 - INSTALL OTHER PRACTICES.

| FABRIC PROPERTIES | VALUES | TEST METHOD |
|---------------------------------|-------------------------|------------------------|
| GRAB TENSILE STRENGTH | 90 LB. MIN | ASTM D-1682 |
| MULLEN BURST STRENGTH | 190 PSI MIN | ASTM D-3786 |
| SLURRY FLOW RATE | 0.3 GAL./MIN./S.F. MAX. | |
| EQUIVALENT OPENING SIZE | 40-80 | US STD. SIEVE CW-02215 |
| ULTRAVIOLET RADIATION STABILITY | 90% MIN | ASTM-G-26 |

SILT FENCE
SCALE: NONE

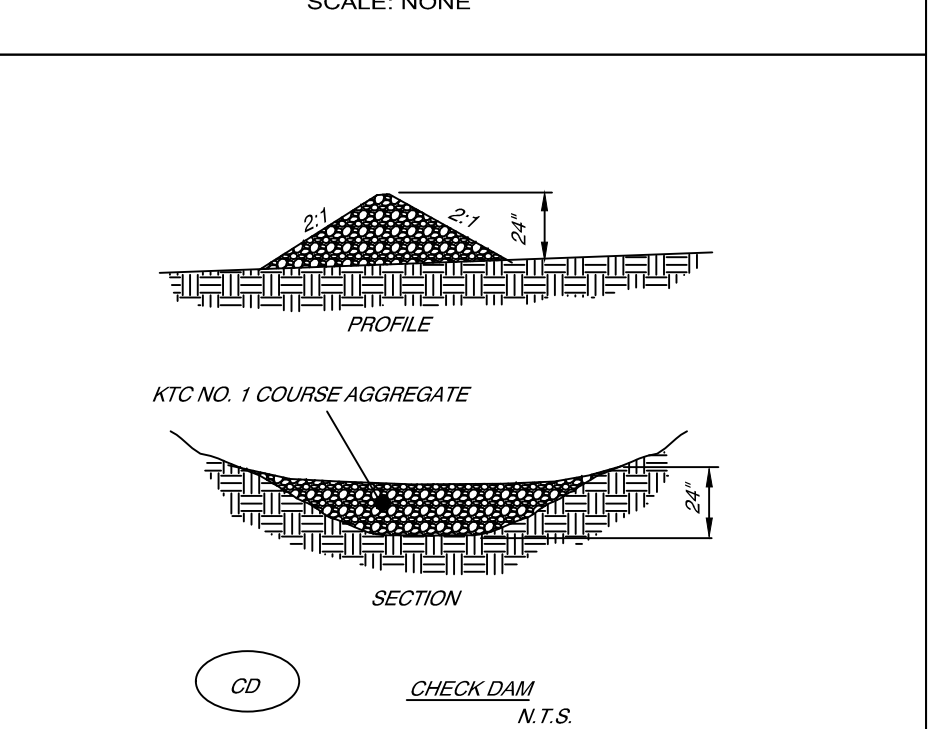

SECTION B-B
CHECK DAM
N.T.S.

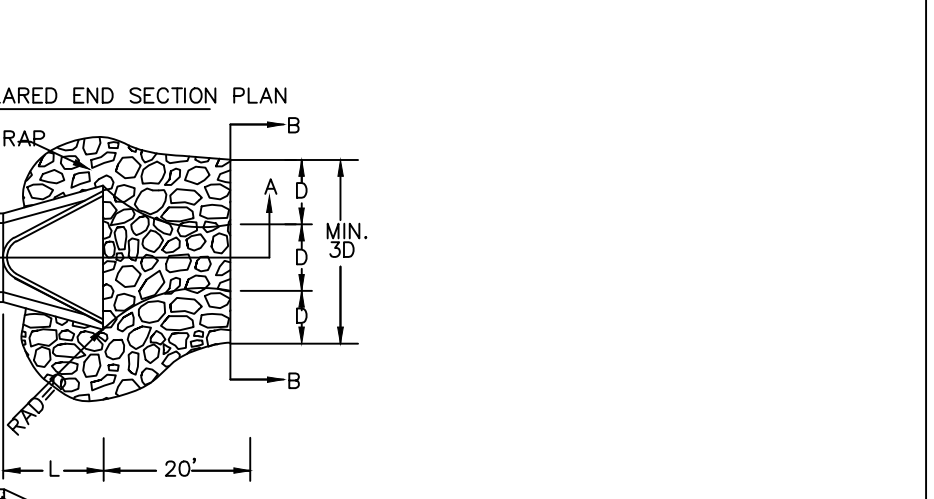

FLARED END SECTION PLAN

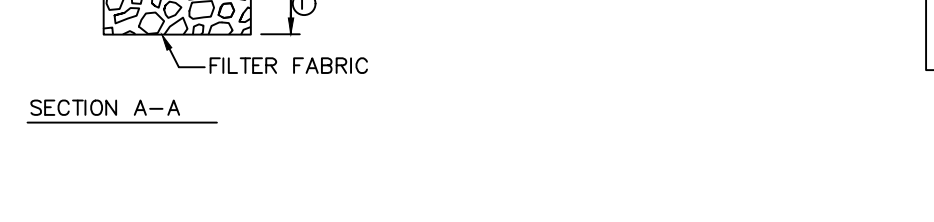

SECTION A-A

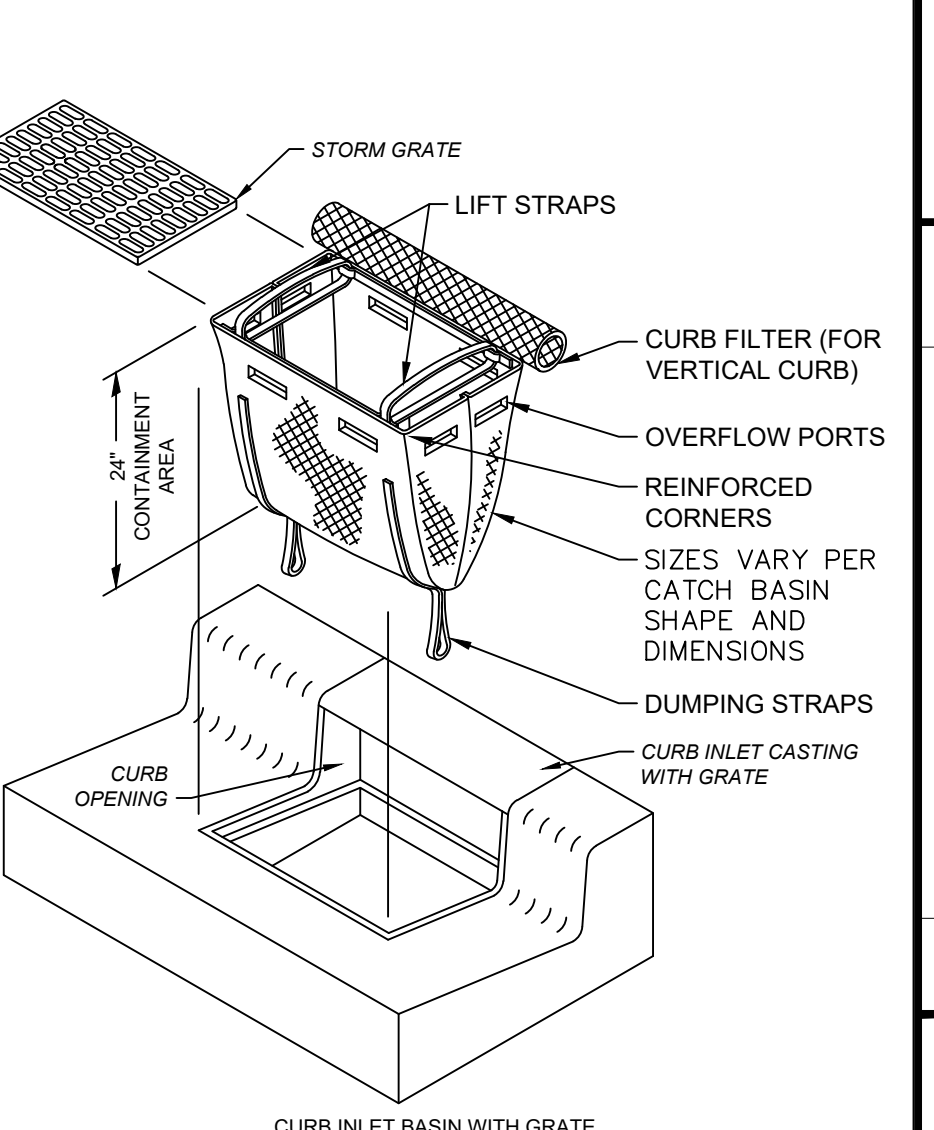
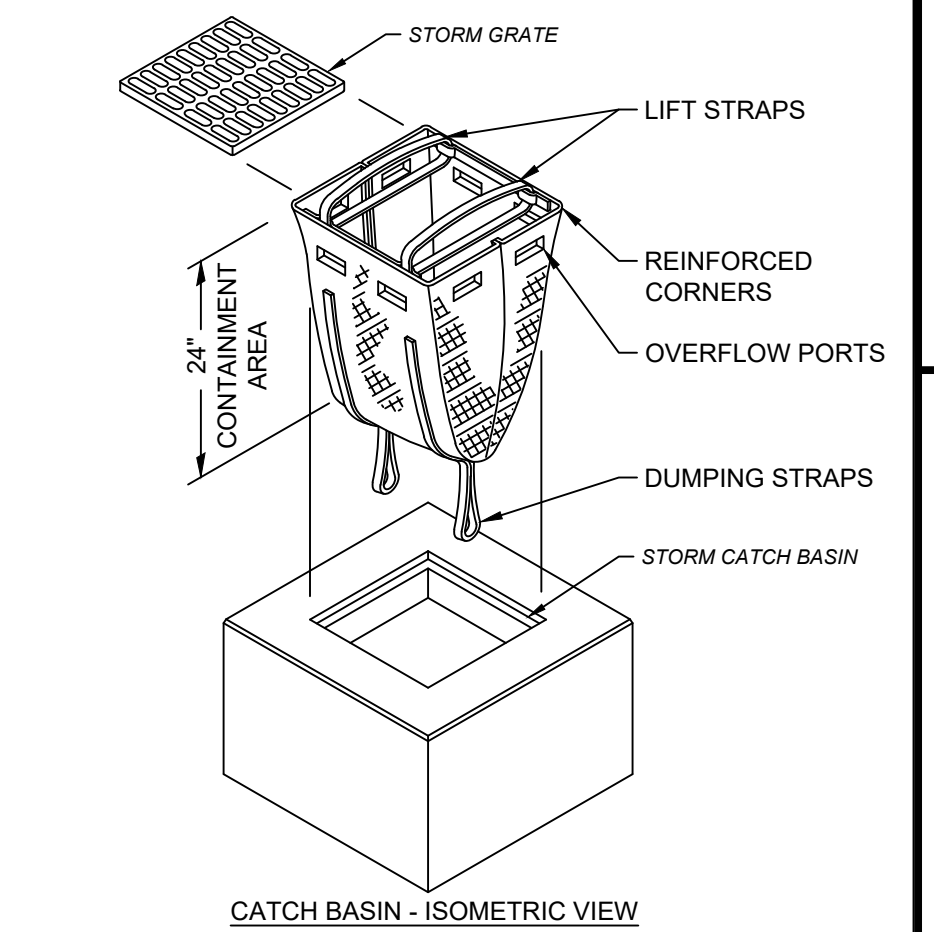

STORM DRAIN INLET PROTECTION DETAIL
SCALE: NONE

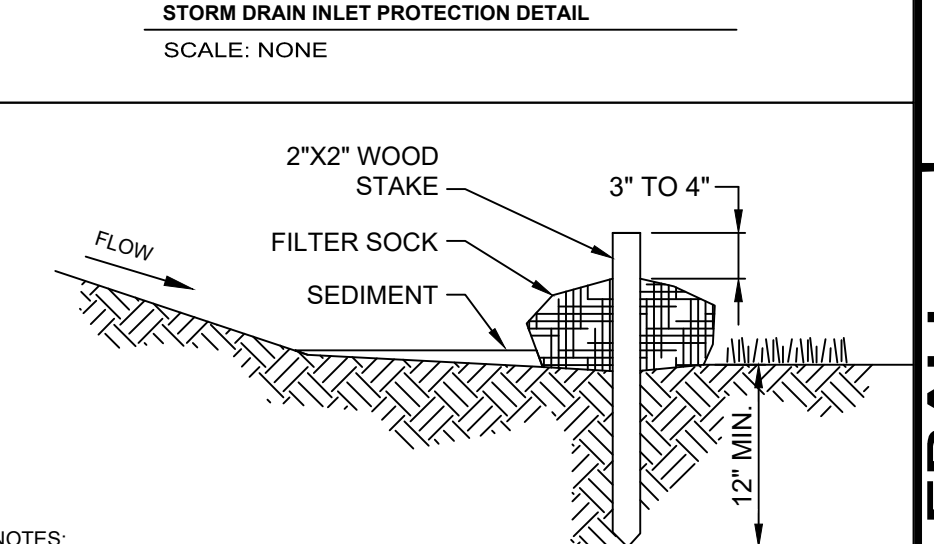

- NOTES:**
- FILTER SOCKS SHALL BE 3 OR 5 MIL CONTINUOUS, TUBULAR, HOPE 3/8" KNITTED MESH NETTING MATERIAL, FILLED WITH COMPOST.
 - COMPOST SHALL BE WEED, PATHOGEN AND INSECT FREE, FREE OF ANY REFUSE, CONTAMINANTS OR OTHER MATERIALS TOXIC TO PLANT GROWTH. BE DERIVED FROM A WELL-DECOMPOSED SOURCE OF ORGANIC MATTER, AND CONSIST OF PARTICLES RANGING FROM 3/8" TO 2".
 - FILTER SOCKS SHALL BE PLACED ON A LEVEL LINE ACROSS SLOPES PARALLEL TO THE BASE OF THE SLOPE.
 - FILTER SOCKS SHALL BE PLACED AT LEAST 5' FROM THE TOE OF SLOPE FOR SEDIMENT DEPOSIT.
 - BUILT UP SEDIMENT SHALL BE REMOVED WHEN IT HAS REACHED 1/3 THE FILTER SOCK HEIGHT.
 - WHEN A FILTER SOCK IS NO LONGER REQUIRED, IT SHALL BE DISPERSED ON-SITE.
 - THE MAXIMUM DRAINAGE AREA PER 100 FEET OF FILTER SOCK IS 1/2 ACRE AND IS DEPENDENT ON THE SLOPE.

| SLOPE | RATIO (H:V) | 8' | 12' | 18' | 24' |
|-----------|-------------|------|------|------|------|
| 0% - 2% | 0 - 50:1 | 125' | 250' | 300' | 350' |
| 2% - 10% | 50:1 - 10:1 | 100' | 125' | 200' | 250' |
| 10% - 20% | 10:1 - 5:1 | 75' | 100' | 150' | 200' |

FILTER SOCK DETAIL
SCALE: NONE

your trusted advisor
consultants
engineers
architects
planners

| REVISION | DATE | NO | REVIEW | ISSUED FOR: |
|----------|------|----|----------|-------------|
| | | | 07/13/23 | AS SHOWN |
| | | | DGAR | DGAR |
| | | | DGAR | MHEL |

FREEDOM PARK PICKLEBALL COURTS
CITY OF EDGEWOOD
- KENTON COUNTY, KENTUCKY -

STORM WATER POLLUTION PREVENTION PLAN

| | |
|-------------|--------|
| PROJECT NO. | 231224 |
| DISCIPLINE | CIVIL |
| SHEET NAME | C10 |
| SHEET | 10 |
| OF | 10 |